

APPENDIX D

ARCHAEOLOGICAL SURVEY FOR THE FORRESTER CREEK PROJECT ASM Affiliates, December 19, 2005

December 19, 2005

Denise Roemer
PBS&J
9275 Sky Park Court, Suite 200
San Diego, California 92123

Re: Archaeological Survey for the Forrester Creek Project, El Cajon, San Diego County,
California

Dear Ms. Roemer:

This letter report summarizes the results of an archaeological study conducted by ASM Affiliates, Inc. (ASM) for the Forrester Creek Project. The study consisted of a survey and records search. The records search identified three previously recorded sites within the property boundary; these sites were not relocated during the survey. The area where the sites were recorded has been graded. No previously unrecorded sites were identified during the survey. Due to grading and bulldozing of the property, no evidence of the three previously recorded sites remains, therefore no adverse impacts to cultural resources will result from project implementation and no mitigation recommendations are necessary.

Project Description

The Forrester Creek project area is located in an unsectioned portion of Township 15 South, Range 1 West of the El Cajon, California USGS 7.5' topographic quadrangle (Figures 1 and 2). The proposed Forrester Creek Industrial Park is located on approximately 35 acres at the northwest corner of Weld Boulevard and Cuyamaca Street in El Cajon, California. The site is a part of the Gillespie Field Airport, an approximately 750-acre general aviation airport owned and operated by the County of San Diego.

Existing industrial development at Gillespie Field includes approximately 160 acres, of which the Forrester Creek site is the last large contiguous parcel that can be developed for industrial purposes. The balance of airport property is designated for aviation uses except for an approximately 10-acre area along the west side of Marshall Avenue just north of Billy Mitchell Drive.

The Forrester Creek project area is designated for commercial/industrial use by the Gillespie Field Special Development Area plan (Figure 3). The City of El Cajon General Plan designates the site for open space uses. The proposed project will require a General Plan

Amendment and a rezone to the M zone. Proposed site use will include 470,500 square feet of multi-tenant industrial space, combining light industrial and warehouse uses which will be built in three phases. Tenants will primarily be East County-based businesses and others wishing to have a central county location.

Records Search Results

A records search was conducted for the project at the South Coastal Information Center. Results of the search indicate that there are a total of eleven previously recorded sites within a one-mile radius of the project boundary (Table 1), three of which are located within the current project area. Of the sites recorded within a one-mile radius, most of which are prehistoric in age; one site has both prehistoric and historic components. A number of the other sites found near the project area are relatively small artifact scatters, which could represent short-term, or temporary campsites.

Table 1. Sites Located Within One Mile of the Project Area

Site No.	Site Type	Approximate Location	Site Size	Date	Recorded By	Artifacts/Features
SDI-141	No description given	> 5,000 feet NE	N/A	N/A	Treganza	Very little information given in site form
SDI-5049	Lithic scatter and milling site	Within project area	110m x 115m	1979	A.C. Oetting	Flaked and ground stone tools, milling outcrops
SDI-5051	Milling site	Within project area	10m x 15m	1979	A.C. Oetting	Bedrock milling
SDI-5052	Milling site	Within project area	50m x 50m	1979	A.C. Oetting	Bedrock milling
SDI-5053	Lithic scatter and milling site	4,500 feet NW	200m x 200m	1986	J. Corum	Bedrock milling, rock shelter, lithic scatter, pottery
SDI-5050	Lithic scatter and milling site	> 5,000 feet NW	40m x 130m	1979	Roy Pettus	Bedrock milling, rock shelter, lithic scatter, pottery
SDI-5535	Lithic scatter and Historic	> 5,000 feet SW	305m x 105m	1986	Martin Rosen	Historic structure, flaked and ground stone tools
SDI-7603	Destroyed remains of a village site	5,000 feet N	150m x 150m	1981	Hector	Flaked and ground stone tools, milling outcrops
SDI-10863	Lithic scatter	2,000 feet SE	450m x 75m	1987	Anna Noah	Quartzite flakes, unifacially and bifacially flaked tools
P-016044	Shell scatter	4,000 feet SE	10m x 5m	1998	Brian Smith	Marine shell
P-016045	Shell scatter	4,250 feet SE	4m x 4m	1998	Brian Smith	Marine shell

The three previously recorded sites located within the project area are described as follows:

SDI-5049: This is a prehistoric habitation site located in the southeast portion of the project area. The site was recorded by Oetting in 1979 as five bedrock outcrops with milling features and associated lithic, ground stone and ceramic artifacts. This site was not relocated by the current survey.

SDI-5051: This is a bedrock milling site located in the east-central portion of the project area. The site was recorded by Oetting in 1979 as six milling features located just southwest of the bridge over Forrester Creek and 10-20 meters west of Cuyamaca Road. Oetting also noted two pieces of ground stone located approximately 60 meters to the southwest. This site was not relocated during the current survey.

SDI-5052: This is a bedrock milling site located in the northwestern portion of the project area. The site was recorded by Oetting in 1979 as nine milling features located on three isolated bedrock outcrops and one flake tool. Oetting noted that more than 12 pieces of ground stone were located along a wall of a house to the north of the site and that these artifacts possibly derived from the site. This site was not relocated during the current survey.

The records search results did not indicate that these sites were tested, or that a survey or excavation report was prepared as part of the site recording process. Contact with the County of San Diego, Department of Public Works, did not result in the identification of a survey or testing report. It is possible that an excavation report exists, but is no longer on file at the Information Center or at the County.

Survey Methods and Results

ASM Associate Archaeologists Michael Garnsey and Ken Moslak conducted fieldwork for the proposed Forrester Creek Project on December 5, 2005 under my supervision. Fieldwork involved intensive pedestrian survey of the entire project property at 20-meter transect intervals. Field notes and photographs documenting the results of the survey were prepared. No cultural resources were identified during survey of the project area.

The majority of the project property is very level and appears to have been graded, although the northeast corner of the project is bisected by a concrete-lined section of Forrester Creek and there are two areas of higher ground within the project area. The first elevated portion of the project area is located in the center of the property and appears to have been disturbed by construction of a driving range. The second elevated portion is a graded dirt parking lot associated with the county operations area, located to the west of the project area. The majority of the project area is covered with dense non-native grass that had recently been mowed, partially obscuring ground visibility. The impact area for the driving range has been completely cleared of vegetation and topsoil. A small, one-foot-deep trench located on the west and south end of the impact area exposed decomposed granite bedrock. The area around the concrete-lined section of Forrester Creek shows evidence of heavy disturbance, probably associated with the lining of the creek. Large amounts of imported crushed rock and gravel are present along the creek. A fairly large amount of modern debris, including metal, plastic, paper, and Styrofoam, broken concrete and asphalt was scattered across the project area.

Conclusions and Management Considerations

No cultural resources were identified within the Forrester Creek project property during the field survey. However, the records search did identify three previously recorded sites; none of these sites were relocated by an intensive pedestrian survey. Our conclusion is that these sites have been destroyed. The area where the sites was recorded has been graded. Although the ground surface within the project area was partially obscured by dense vegetation, visibility was adequate to determine that the area is unlikely to contain cultural resources. Additionally, a considerable amount of modern clearing and grading activities have taken place to construct a driving range within the project property; as such, the property is not likely to contain buried archaeological deposits. Therefore, project implementation will not impact significant archaeological resources either listed on or eligible for the California Register, and no mitigation measures are necessary.

Should you have any questions or concerns, please do not hesitate to contact me.

Sincerely,

A handwritten signature in cursive script, reading "Susan M. Hector".

Susan M. Hector, Ph.D.
Senior Archaeologist

Attachments: Project vicinity map
Project area map
Project site plan



Figure 1. Project Vicinity Map

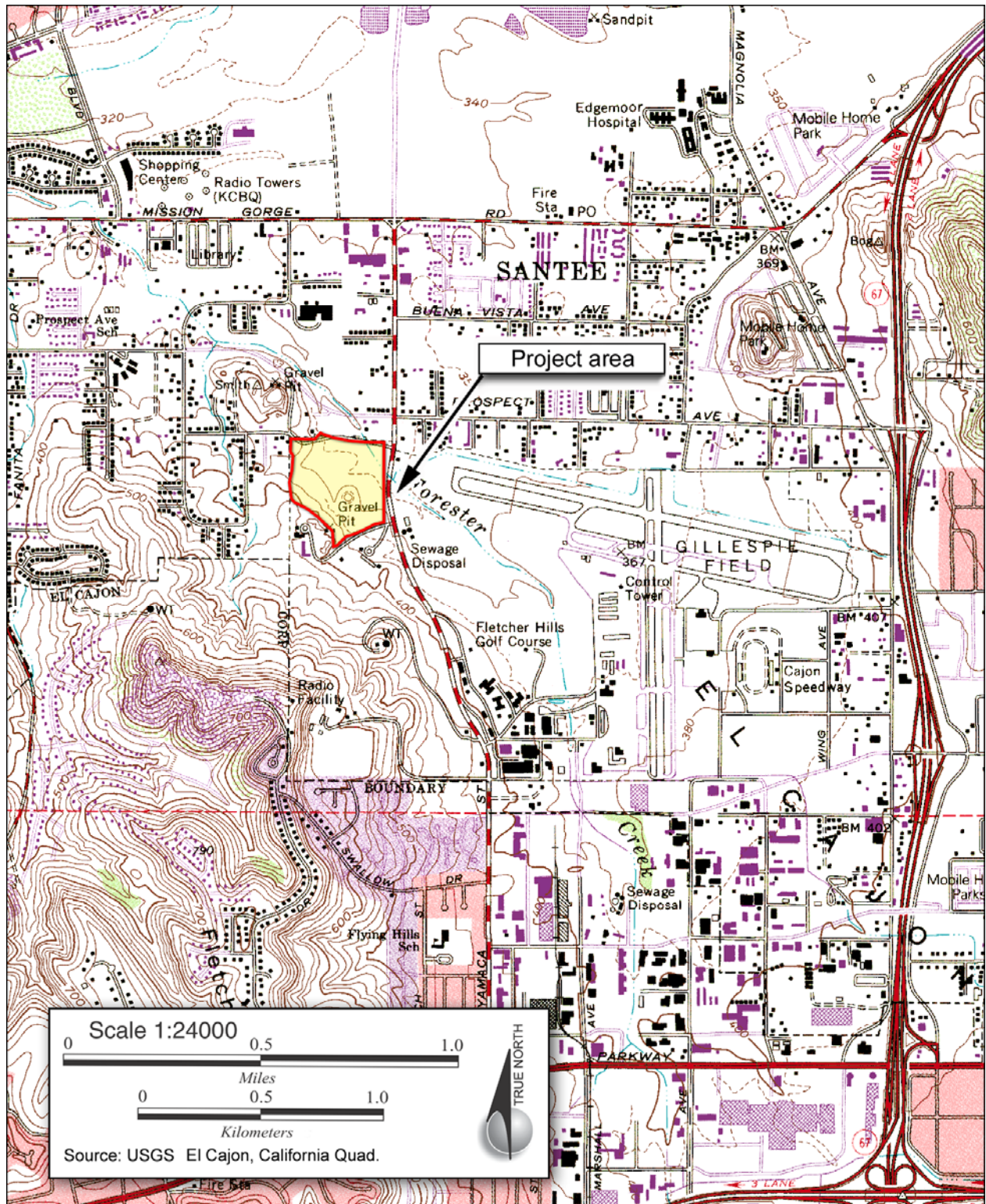

Figure 2. Project Area Map

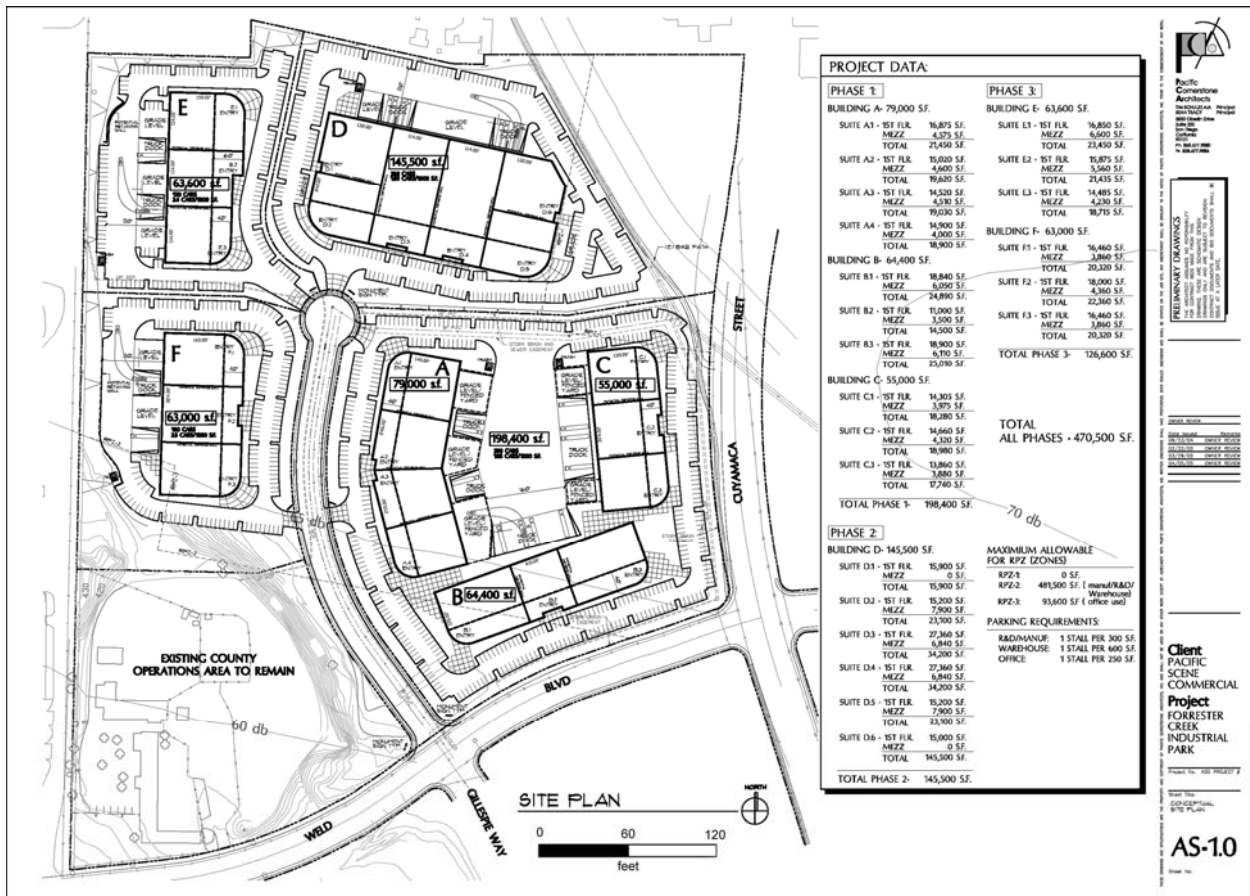

Figure 3. Project Site Plan

