

ABBREVIATIONS:

ASOS	Automated Surface Observation System
BRL	Building Restriction Line
E	Existing
EL	Elevation
FBO	Fixed Base Operator
GPS	Global Positioning System
ODALS	Omnidirectional Approach Lighting System
OFZ	Obstacle Free Zone
PAPI	Precision Approach Path Indicator
PR	Proposed
PS	Sewer Pump Station
REIL	Runway End Identifier Lights
ROFA	Runway Object Free Area
RSA	Runway Safety Area
R/W	Runway
TOFA	Taxiway Object Free Area
T/W	Taxiway

BUILDINGS KEY:

①	FBO Maintenance Hangar
②	T-Hangars
③	Fuel Island
④	Fire Attack Shop
⑤	Fire Attack Hangar
⑥	Storage
⑦	Water/Fire Retardant Tanks
⑧	Fire Attack Helipad
⑨	Fire Attack Base Apron
⑩	Septic System Pond
⑪	Electrical Vault
⑫	Terminal/Administration Building (Future)
⑬	Airport Traffic Control Tower and Existing Administration Building
⑭	Transient Parking
⑮	Wash Rack

REVISIONS:

△	Install Security Fence
△	Existing Practice Helipad
△	Existing Compass Rose to be Future Helipad
△	Rehabilitate/Overlay Proposed Transient Apron (Future Terminal/Transient Apron)
△	Install ATCT Equipment
△	Proposed Run-Up Area with Relocated Compass Rose
△	Remove Bird and Wildlife Attractant Area
△	Revised to show Hangar Concept E-2
△	Proposed Vacation of Montecito Rd. Westerly to ATCT, Install Electronic Access Point
△	Proposed Rotating Beacon on Top of ATCT
△	Proposed Vernal Pool Mitigation Area
△	Tie-Downs and Pr. Taxilane

DEVIATIONS FROM FAA DESIGN STANDARDS			
DESIGN STANDARD	REQUIRED	EXISTING	ACTION
Obstacle Free Zone (South side of R/W)	200 ft.	155 ft.	ROFZ to be cleared
Runway Object Free Area (South side of R/W)	250 ft.	155 ft.	ROFA to be cleared
Runway Holding Position Markings	200 ft.	125 ft.	To correct during slurry seal

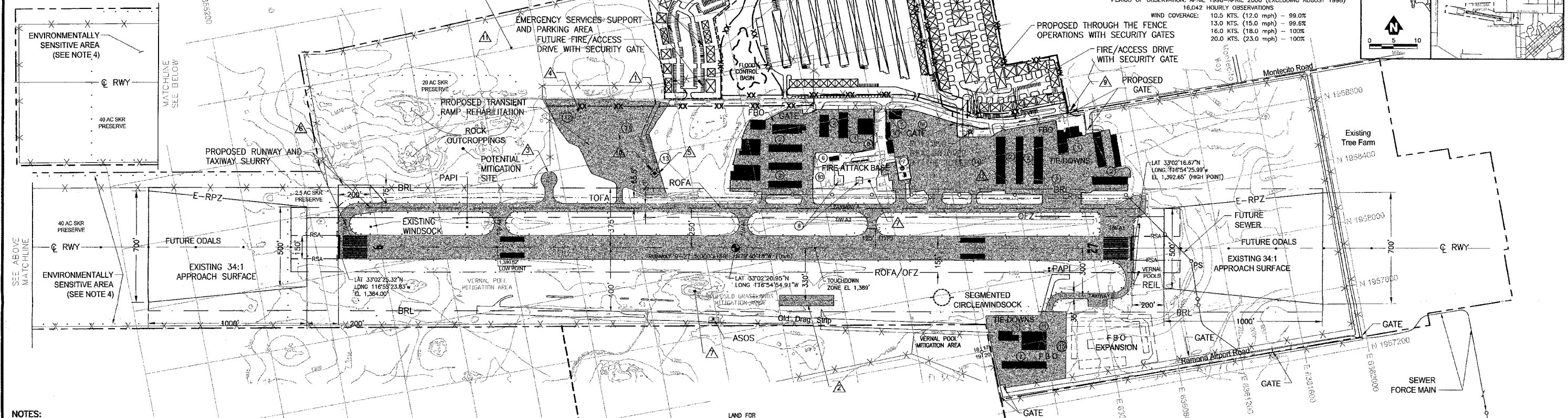
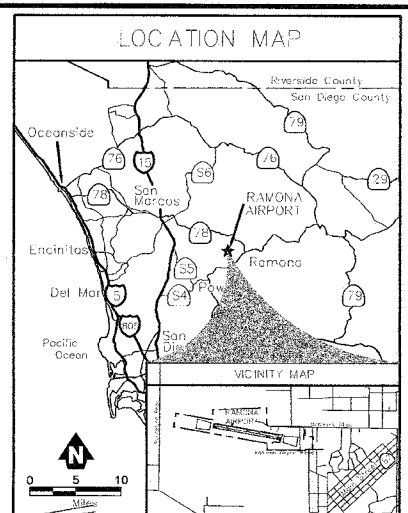
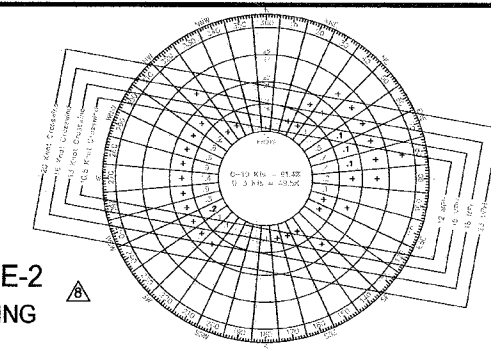

NOTES:

- All elevations are in feet above Mean Sea Level.
- California Coordinate System, Zone 6, NAD 83.
- The applicable standard for RSA width is 150 feet. The existing runway is also 150 feet wide.
- Lateral extent of Environmentally Sensitive Area defined by Airport property line on both sides of extended runway centerline.
- At the same time as the agreement for through the fence operations is completed the County and Ramona Air Center (RAC) will enter into an aeronautical lease for the developable portions of the County Property, for a minimum of twenty (20) acres, that will provide for the development of the leased area by RAC for aircraft hangaring and support services. The proposed lease will provide for the development to take place in phases of approximately five (5) acres each. Development on first phase must be completed within 4 years after Lease and Through the Fence Operations agreements are approved by County. At least one (1) of the remaining phases shall be completed each subsequent year thereafter subject to market conditions in the opinion of Ramona Air Center.

RECOMMENDED BY: *[Signature]* DATE: 3/24/09
 COUNTY AIRPORT MANAGER
 APPROVED BY: *[Signature]* DATE: 3/24/09
 COUNTY AIRPORT ENGINEER
 PEPPER DORR WATKINS, AIRPORT ENGINEER

RUNWAY END DATA		
APPROACH END OF RUNWAY:	9	27
APPROACH VISIBILITY:	Existing > 1 Mile	> 1 Mile
MINIMUMS	Future 1 Mile	1 Mile
RUNWAY END COORDINATES (NAD 83)	Latitude	Existing 33° 02' 25.23"N 33° 02' 16.67"N
	Longitude	Existing 116° 55' 23.83"W 116° 54' 25.99"W

	RUNWAY 9-27	
	EXISTING	FUTURE
EFFECTIVE GRADIENT	0.25%	Same
PAVEMENT STRENGTH (10000) S/D/DI	75/155/200	Same
PAVEMENT MATERIAL	ASPHALT	Same
RUNWAY/TAXIWAY LIGHTING	Medium Intensity	Some
RUNWAY MARKING	Nonprecision	Some
NAVIGATIONAL AIDS	None	Some
WIND COVERAGE % (13 KNOTS)	99.6	Same
VISUAL AIDS	PAPI (9/27 3.5')	ODALS (9/27)
	REIL (27)	REIL (9)
FAR PART 77 CATEGORY	Nonprecision (9)	Nonprecision
APPROACH SLOPE (Required/Clear)	34:1/50+1	Some
MAXIMUM ELEVATION ABOVE MSL	1,392.65'	Same
RUNWAY LENGTH AND WIDTH	5,000' X 150'	Same
RUNWAY SAFETY AREA LENGTH/WIDTH	300'/150'	Some
RUNWAY OBJECT FREE AREA LENGTH/WIDTH	300'/500'	Some

AIRPORT DATA			
AIRPORT SERVICE LEVEL (NPIAS)	Existing	Reliever	Future
AIRPORT REFERENCE POINT (NAD 83)	Latitude	33° 02' 20.95" N	Some
	Longitude	116° 54' 54.91" W	Some
AIRPORT ELEVATION (Above Mean Sea Level)	1,392.71'	Some	
MEAN MAX. TEMP. (Hottest Month)	94° F (July)	Some	
AIRPORT NAVIGATIONAL AIDS	PAPI (9/27)	CPS	
AIRPORT REFERENCE CODE	REIL (27)	Some	
CRITICAL AIRCRAFT	Fokker F-28-2000	Some	
AIRPORT ACREAGE	Fee Simple Easement	378	Some
	Hangar Units	123	171
AIRCRAFT PARKING	FBO Area Tiedowns	85	Some
	County Apron (Incl. Transient)	19	50+

LEGEND		
	EXISTING	ULTIMATE
AIRFIELD PAVEMENT		
AIRPORT BOUNDARY		
AIRPORT REFERENCE POINT (ARP)		Some
BUILDINGS		
BUILDING RESTRICTION LINE (BRL)		Some
GROUND CONTOURS		Some
FENCE		Some
OBSTACLE FREE ZONE		Some
ROAD/VEHICLE PARKING		
RUNWAY OBJECT FREE AREA		Some
RUNWAY SAFETY AREA		Some
SECTION CORNER		Some
TAXIWAY OBJECT FREE AREA		Some
ENVIRONMENTAL AREA BOUNDARY		Some
PROPOSED BOX HANGAR AND T-HANGARS		Some
CONCEPTUAL DEVELOPMENT		

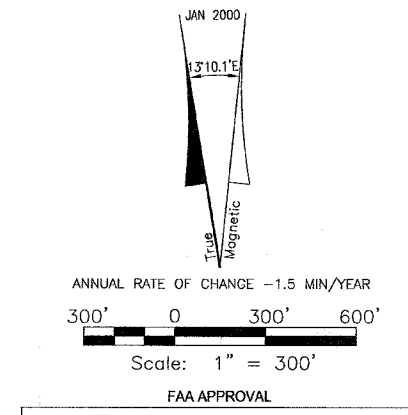

NO.	DATE	REVISION	BY	APP.
7	3/12/09	Revised to Show Hangar Concept E-2		SWM
6	4/3/07	Revised Per FAA Comments		SWM
5	10/20/06	Revised Per County/FAA Comments		SWM
4	5/17/06	Revised Per County Comments		SWM
3	3/8/06	Revised to Show Hangar Concept E-1		SWM
2	3/2/05	Revised Per FAA Comments		DPS PD
1	6/2003	Incorporate A.I.P. Project No. 05, Runway and Taxiway extension.		DPS RLS

AIRPORT LAYOUT PLAN

RAMONA AIRPORT
RAMONA, CALIFORNIA

COUNTY OF SAN DIEGO
DEPARTMENT OF PUBLIC WORKS

DESIGNED: DPS CHECKED: DPS
 DRAWN: AWS DATE: July 31, 2007

SHEET 1 OF 1