

1 inch = 80 feet

PRD Parcel

Road Maintained by PRD

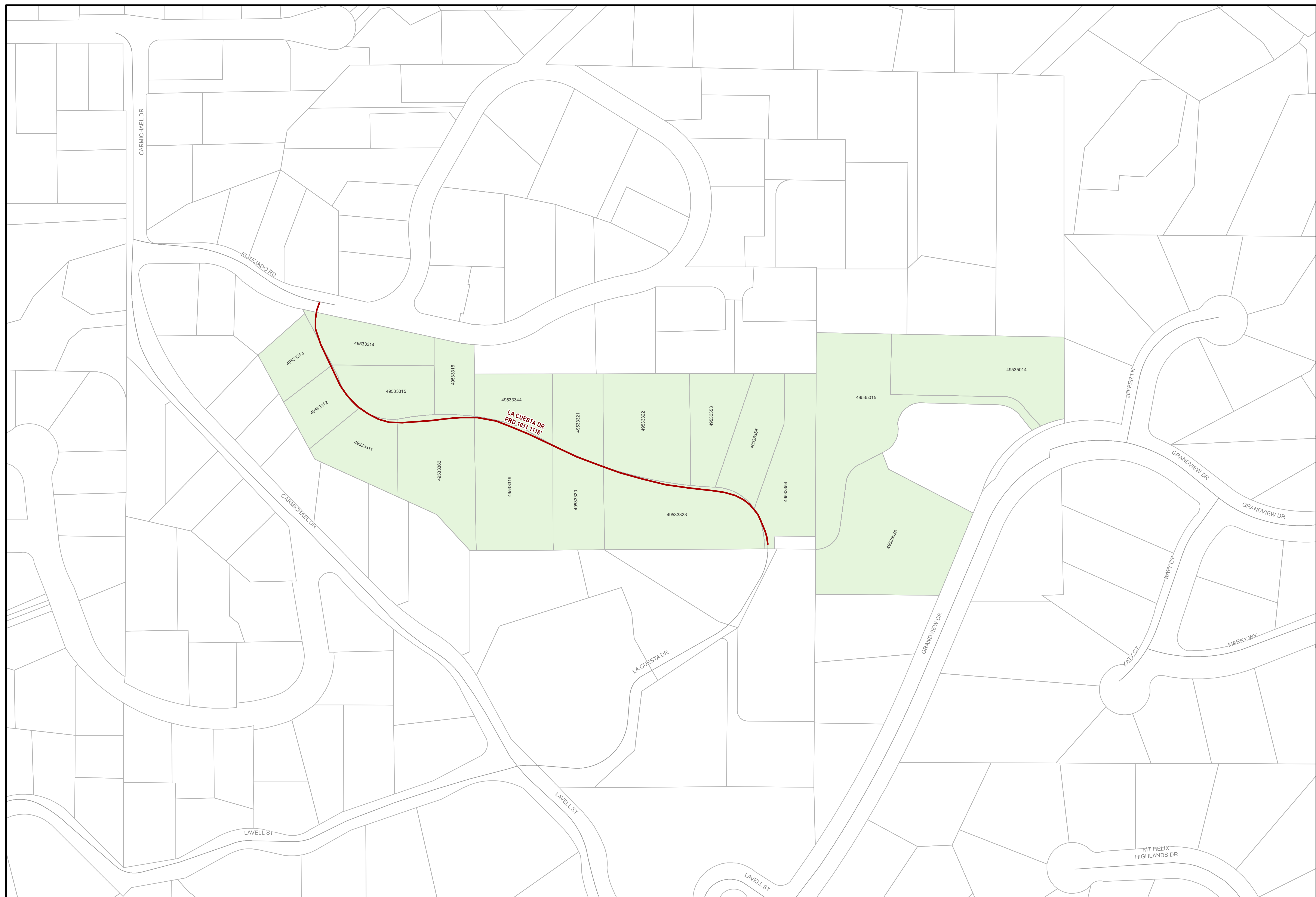

County of San Diego
 Planning & Development Services
 Land Use & Environmental Group
 Geographic Information Service

THIS MAP/DATA IS PROVIDED WITHOUT WARRANTY OF ANY KIND, EITHER EXPRESS OR IMPLIED, INCLUDING BUT NOT LIMITED TO, THE IMPLIED WARRANTIES OF MERCHANTABILITY AND FITNESS FOR A PARTICULAR PURPOSE. Note: This product may contain information from the SANDAG Regional Information System which cannot be reproduced without the written permission of SANDAG. This product may contain information reproduced with permission granted by Robert McNealy & Company to SanGIS. The map is copyrighted by Robert McNealy & Company. It is unlawful to copy or reproduce all or any part thereof, whether for personal use or resale, without the prior written permission of Robert McNealy & Company. Copyright SanGIS 2012. All Rights Reserved. Full text of the legal notice can be found at: http://www.sandag.org/legal_notice.htm

PERMANENT ROAD DIVISION — LA CUESTA DRIVE 1011

Path: P:\Special Districts\PRD\mxd\map_series.mxd — Date: 1/26/2015