

SECTION A-A
SCALE: HORIZ. 1"=200' VERT. 1"=200'

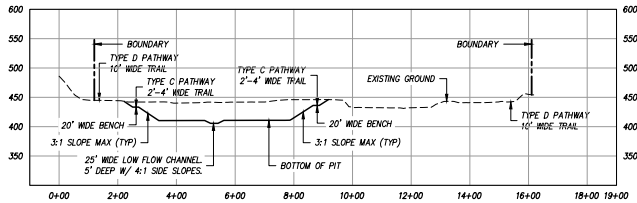

SECTION B-B
SCALE: HORIZ. 1"=200' VERT. 1"=200'

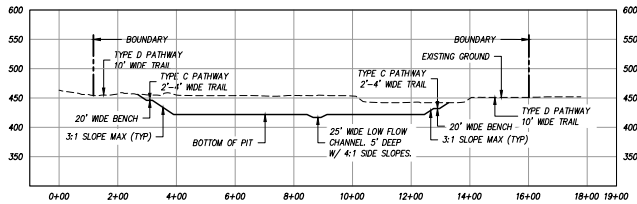

SECTION C-C
SCALE: HORIZ. 1"=200' VERT. 1"=200'

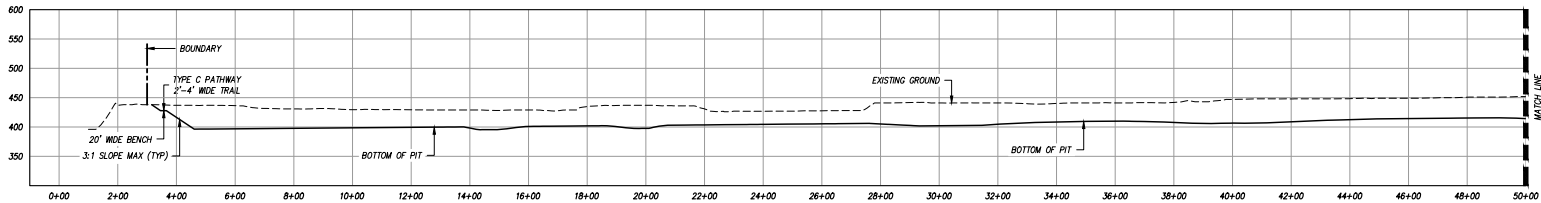

SECTION D-D
SCALE: HORIZ. 1"=200' VERT. 1"=200'

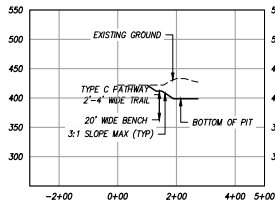

SECTION E-E
SCALE: HORIZ. 1"=200' VERT. 1"=200'

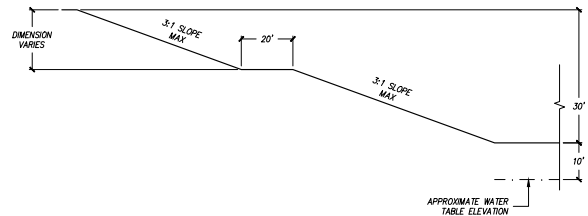

PIT GRADING TYPICAL SECTION
SCALE: 1"=40'

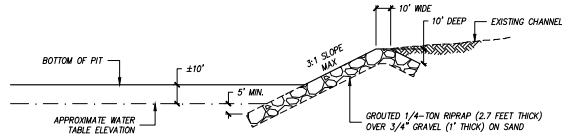

DROP STRUCTURE TYPICAL SECTION
SCALE: 1"=40'

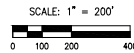
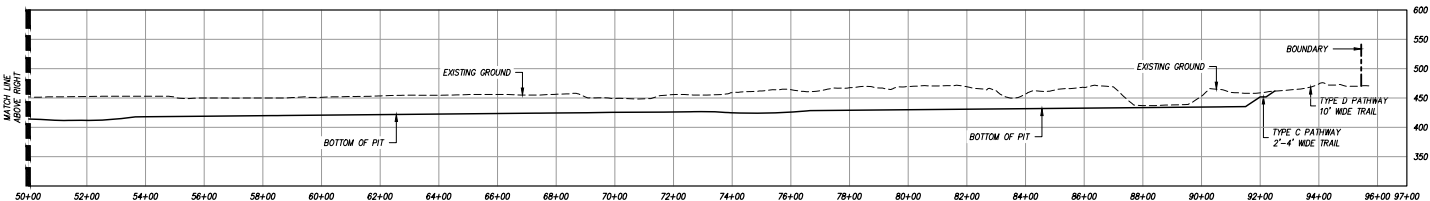

COUNTY APPROVED CHANGES		
No.	Description	Approved by
1	ORIGINAL	

PERMITS	
HABITAT LOSS PERMIT NO.	COUNTY OF SAN DIEGO
N.O.I. NO.	DEPARTMENT OF PUBLIC WORKS
SPECIAL PLAN AMENDMENT	
SPECIAL USE PERMIT NO.	
GRADING PERMIT NO.	
TENTATIVE MAP NO.	

BENCHMARK	
DESCRIPTION	COUNTY OF SAN DIEGO BENCHMARK
LOCATION	
RECORD FROM	
ELEVATION	
DATE	NOV 29

PRIVATE CONTRACT	
SHEET	6
4	
RECLAMATION PLAN FOR:	
EL MONTE VALLEY	
CROSS SECTIONS	
CALIFORNIA COORDINATE INDEX: 254-1803	
Approved	Engineer of work
COUNTY ENGINEER	
DATE	
Signature	

FILE NO.

July 25, 2018

FOR REVIEW ONLY

El Monte Sand Mining Container Plant Palettes and Seed Mixes – January 2013

Container Plant Palettes

Table 14 Vegetated Streambed Container Plants				
Species	Common Name	Container Size	Spacing (feet on center)	Density per Acre
<i>Artemisia douglasiana</i>	Douglas' mugwort	1 gallon	6	220
<i>Artemisia palmieri</i>	San Diego sagewort	1 gallon	12	140
<i>Iva haydenii</i>	San Diego marsh elder	1 gallon	12	60
<i>Munroa rigida</i>	Downgrass	1 gallon	8	130
<i>Rosa californica</i>	California rose	1 gallon	6	130
Total				680

Table 15 Riparian Forest Container Plants				
Species	Common Name	Container Size	Spacing (feet on center)	Density per Acre
<i>Artemisia douglasiana</i>	Douglas' mugwort	1 gallon	10	100
<i>Artemisia palmieri</i>	San Diego sagewort	1 gallon	12	40
<i>Baccharis salicifolia</i>	Mule fat	1 gallon	14	160
<i>Ericameria palmieri</i> var. <i>palmieri</i>	Palmer's sagewort	1 gallon	25	50
<i>Munroa rigida</i>	Downgrass	1 gallon	10	80
<i>Platanus racemosa</i>	Western sycamore	5 gallon	60	20
<i>Pluchea sericea</i>	Arrow weed	1 gallon	15	70
<i>Populus fremontii</i>	Fremont cottonwood	5 gallon	40	40
<i>Quercus agrifolia</i>	Coast live oak	5 gallon	60	40
<i>Salix exigua</i>	Sandbar willow	1 gallon	15	40
<i>Salix goodenifolia</i>	Black willow	1 gallon	50	16
<i>Salix lasiolepis</i>	Red willow	1 gallon	20	64
<i>Salix lasiolepis</i>	Arroyo willow	1 gallon	16	52
<i>Sambucus mexicana</i>	Blue elderberry	5 gallon	35	40

Species	Common Name	Container Size	Spacing (feet on center)	Density per Acre
<i>Thalictrum fendleri</i> var. <i>polycarpum</i>	Many fruit meadow-rue	1 gallon	30	30
Total				890

Table 16 Riparian Scrub Container Plants				
Species	Common Name	Container Size	Spacing (feet on center)	Density per Acre
<i>Artemisia californica</i>	California sagebrush	1 gallon	25	70
<i>Artemisia dracunculoides</i>	Tarragon	1 gallon	12	80
<i>Artemisia palmieri</i>	San Diego sagewort	1 gallon	14	110
<i>Baccharis pilularis</i>	Coyote brush	1 gallon	35	90
<i>Baccharis salicifolia</i>	Mule fat	1 gallon	10	270
<i>Ericameria palmieri</i> var. <i>palmieri</i>	Palmer's sagewort	1 gallon	30	80
<i>Isocornis menziesii</i> var. <i>menziesii</i>	Coastal goldenbush	1 gallon	35	60
<i>Pluchea sericea</i>	Arrow weed	1 gallon	20	50
<i>Salix exigua</i>	Sandbar willow	1 gallon	20	40
<i>Salix lasiolepis</i>	Arroyo willow	1 gallon	35	30
<i>Sambucus mexicana</i>	Blue elderberry	5 gallon	40	60
Total				890

Table 17 Coastal Sage Scrub Container Plants				
Species	Common Name	Container Size	Spacing (feet on center)	Density per Acre
<i>Artemisia californica</i>	California sagebrush	1 gallon	10	230
<i>Eriogonum fasciculatum</i>	California buckwheat	1 gallon	30	30
<i>Isocornis menziesii</i> var. <i>menziesii</i>	Coastal goldenbush	1 gallon	20	60

<i>Malacothamnus fasciculatus</i>	Bush mallow	1 gallon	30	30
<i>Malacothamnus laurina</i>	Laurel sumac	1 gallon	50	15
<i>Mimulus aurantiacus</i>	Bush monkeyflower	1 gallon	30	40
<i>Stipa pulchra</i>	Footfall needlegrass	1 gallon	12	160
<i>Stipa pulchra</i>	Purple needlegrass	1 gallon	12	110
Total				680

Seed Mixes

Table 18 Vegetated Streambed Seed Mix				
Species	Common Name	Lbs. per Acre	Min. Percent Purity/ Germination	Lbs. Pure Live Seed (PLS) per Acre
<i>Artemisia pilularis</i>	Western sagebrush	5.0	45/45	1.01
<i>Artemisia douglasiana</i>	Douglas' mugwort	6.0	15/40	0.36
<i>Artemisia palmieri</i>	San Diego sagewort	4.0	20/50	0.40
<i>Iva haydenii</i>	San Diego Marsh elder	4.0	30/30	0.36
<i>Juncus bufonius</i>	Toadswain	3.0	95/90	1.71
Total		22		3.84

Table 19 Riparian Forest Seed Mix				
Species	Common Name	Lbs. per Acre	Min. Percent Purity/ Germination	Lbs. Pure Live Seed (PLS) per Acre
<i>Artemisia pilularis</i>	Western sagebrush	4.0	45/45	0.81
<i>Artemisia californica</i>	California sagebrush	3.0	30/60	0.54
<i>Artemisia douglasiana</i>	Douglas' mugwort	4.0	15/40	0.24
<i>Artemisia palmieri</i>	San Diego sagewort	3.0	20/50	0.30
<i>Baccharis pilularis</i>	Coyote brush	3.0	10/50	0.15
<i>Comptosia bicolor</i>	California sun-rup	1.0	90/80	0.72
<i>Isocornis menziesii</i> var. <i>menziesii</i>	Coastal goldenbush	3.0	15/40	0.22

<i>Lupinus hispidus</i>	Singing lupine	1.0	90/75	0.74
<i>Oenothera elaeagnifolia</i>	Tall evening primrose	1.0	98/84	0.82
<i>Phacelia elaeagnifolia</i>	Cattail phacelia	1.0	96/90	0.88
<i>Pluchea sericea</i>	Arrowweed	5.0	70/5	0.07
<i>Rosa californica</i>	California rose	1.0	85/53	0.45
Total		30.0		5.94

MATCHLINE - SEE RIGHT

2' TRAIL CROSSING OF SAN DIEGO RIVER FLOWLINE

TYPE 'C' PRIMITIVE TRAIL
2'-4' WIDE IN A 20' WIDE EASEMENT (TYPICAL)

TYPE 'D' PATHWAY
10' WIDE IN A 20' WIDE EASEMENT (TYPICAL)

TRANSECTS (TYPICAL)

TEST PLOT #1

TEST PLOT #2

2' TRAIL CROSSING OF SAN DIEGO RIVER FLOWLINE

MATCHLINE - SEE LEFT

WEST BOUNDARY DETAIL
SCALE: 1"=400'

TRAIL LEGEND

- TYPE 'C' PRIMITIVE 2'-4' WIDE TRAIL
- TYPE 'D' PATHWAY 10' WIDE TRAIL

REVEGETATION LEGEND

- STREAMBED RECLAMATION
- STREAMBED MITIGATION
- SOUTHERN WILLOW SCRUB RECLAMATION
- SOUTHERN WILLOW SCRUB MITIGATION
- COTTONWOOD WILLOW RIPARIAN FOREST RECLAMATION
- COTTONWOOD WILLOW RIPARIAN FOREST MITIGATION
- COASTAL SAGE SCRUB RECLAMATION
- COASTAL SAGE SCRUB MITIGATION

REVEGETATION NOTE
SEE REVEGETATION PLAN FOR TYPICAL PLANTING LAYOUTS AND HABITAT AREAGES.

San Diego Gas & Electric Company
Reviewed By: _____ Date: _____
Land Management Representative
Valid for 18 months from date of signature

COUNTY APPROVED CHANGES			
No.	Description	Approved by	Date
ORIGINAL			

PERMITS	
HABITAT LOSS PERMIT NO.	
SPECIAL PLAN AMENDMENT	
SPECIAL USE PERMIT NO.	
GRADING PERMIT NO.	
TENTATIVE MAP NO.	
BENCHMARK	
DESCRIPTION	COUNTY OF SAN DIEGO BENCHMARK
LOCATION	
RECORD FROM	
ELEVATION	DATE: NOV 29

PRIVATE CONTRACT	
SHEET 5	COUNTY OF SAN DIEGO DEPARTMENT OF PUBLIC WORKS
6 SHEETS	
RECLAMATION PLAN FOR EL MONTE VALLEY REVEGETATION PLAN	
CALIFORNIA COORDINATE INDEX: 254-1803	
APPROVED COUNTY ENGINEER	DATE: 11/29/09
DESIGNED BY	DATE: 11/29/09
DRAWN BY	DATE: 11/29/09

FILE NO.

July 25, 2018

FOR REVIEW ONLY

EASEMENTS TO SDG&E IN EL MONTE
Document #

Document #	WIDTH/BLANKET
1. NOT USED	
2. NOT USED	
3. 2008-5-8-2008-0248396	12'
4. NOT USED	
5. 1984-4-12_84-133607	12'
6. 1917-7-18_526_442	BLANKET
7. NOT USED	
8. NOT USED	
9. 1916-6-14_714_94	200'
10. 1959-8-10_161635	200'
11. NOT USED	
12. NOT USED	
13. NOT USED	
14. 1928-1-11_1412_338	12'
15. 1959-6-24_7734_517	12'
16. 1916-6-5_710_220	BLANKET
17. 1975-2-11_75-032040	12'
18. NOT USED	
19. NOT USED	
20. 1937-5-19_909-194	12'
21. 1984-9-21_84-358173	12'
22. 1985-1-17_85-016052	12'
23. 1989-9-21_89-626313	12'
24. 1951-12-14_152319	12'
25. 1972-5-16_123282	12'

OTHER EASEMENTS IN EL MONTE
Document #

Document #	Grantee	WIDTH/BLANKET
A. 1986-1-13_86-139229	Rust	20'
B. 1964-3-17_48799	Lakeside Irrigation	10'
C. 1974-23-16_74-282779	SD Flood Control	300'
D. 1975-7-15_75-182897	County of SD	102, 84 & 60
E. 1989-5-15_89-254176	Hering	20'
F. 1936-4-15_488_319	City of SD	25'
G. 1977-1-28_77-034688	SD Municipal Water	19'
H. 1951-10-8_122639	E & W Smith	20'
J. 1953-9-16_4986_255	E & W Smith	BLANKET
K. 1960-3-28_62789	Martin	30'
L. 1964-5-18_63640	Van Owning	30'
M. 1970-2-13_26425	Jackman	20'
N. 1971-12-3_281189	W Smith	30'
O. 1972-2-4_28811	W Smith	30'
P. 1973-2-26_73-0494443	Sloan	20'
Q. 1982-5-18_82-148903	Nimmo	20'
R. 1989-9-15_89-500130	Cantor	20'
S. 2002-5-2_2002-0373361	SDCWA	80'
T. 2007-6-14_2007-0402823	Gorka	20'
U. 1991-07-30_1991-0376221	City of SD	5'

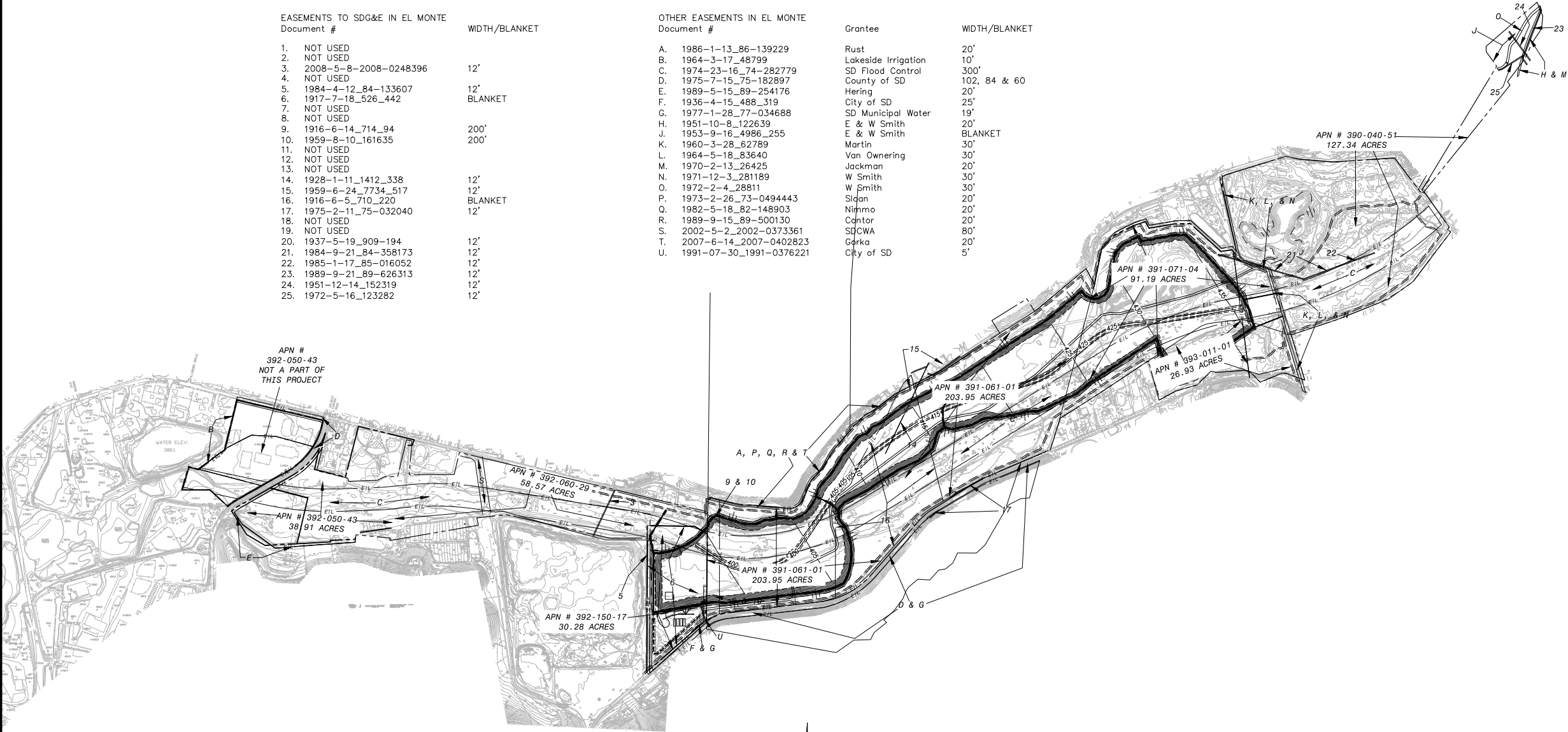

San Diego Gas & Electric
Company

Reviewed By: _____ Date: _____

Land Management Representative
Valid for 18 months from date of signature

COUNTY APPROVED CHANGES			
No.	Description	Approved by	Date
ORIGINAL			

PERMITS	
HABITAT LOSS PERMIT NO.	
N.O.I. NO.	
SPECIFIC PLAN AMENDMENT	
SPECIAL USE PERMIT NO.	
GRADING PERMIT NO.	
TENTATIVE MAP NO.	

BENCHMARK	
DESCRIPTION	COUNTY OF SAN DIEGO BENCHMARK
LOCATION	
RECORD FROM	
ELEVATION	DATUM: NGVD 29

PRIVATE CONTRACT	
SHEET	6
COUNTY OF SAN DIEGO	DEPARTMENT OF PUBLIC WORKS
RECLAMATION PLAN FOR:	
EL MONTE VALLEY EASEMENTS	
CALIFORNIA COORDINATE INDEX: 254-1803	
Approved	Engineer of work
COUNTY ENGINEER	
BY: _____	DATE: _____
_____	_____