

From: Janella Carey  
 To: David Dorn  
 Cc: Sam Whaley  
 Subject: P02014-09-14-015, P02014-02-14-014, P02014-14-014, P02014-14-013, P02014-09-14-013  
 Date: Thursday, December 10, 2015 3:29:25 PM

Hello David -

Thank you for notification of the proposed development along Olde Highway 80 and Lake Jennings Road. MTS requests the provision of two bus stops as part of this project in order to effectively and efficiently serve this project with transit service.

Bus stop locations require a sidewalk adjacent to the curb for the length of the stop. Minimum sidewalk width is 5' feet but the Americans with Disabilities Act requires a minimum of 6' feet sidewalk depth at the stop or ADA loading zone. Landscaping, vegetation, or obstacles should not block passengers from exiting the front or rear doors of ADA buses. ADA ramp deployments should not be obstructed. Stops behind the stop should be mitigated in accordance with the Americans with Disabilities Act.

- A. A "nearside" bus stop located just west of the proposed signalized intersection (as proposed below). It appears the proposed trees may block ADA accessibility. The curb would need to be red, extending east for 150' feet from the intersection. At 75' feet from the intersection, the bus pole would be installed.
- B. A "farside" bus stop just east of the intersection at Rios Canyon Road. The curb would need to be red, extending east 150' feet from the intersection. At 75' feet from the intersection the bus pole would be installed.
- C. MTS can perform work of installation of bus pole.

Please don't hesitate to contact me with questions, or if I can further assist you in identifying transit improvements.

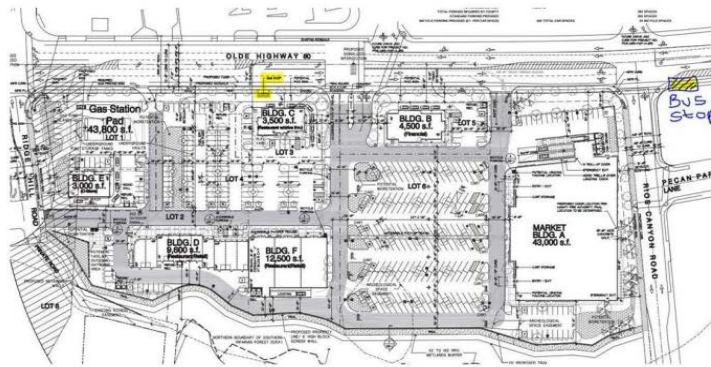

Janella Carey  
 Associate Transportation Planner  
 MTS | Metropolitan Transit System  
 1255 Imperial Ave, Suite 1000  
 San Diego, CA 92101  
 619.557.4261  
[www.sdmmts.com](http://www.sdmmts.com)

E-1  
 E-2  
 E-3  
 E-4  
 E-5

## Response to Comment Letter E Metropolitan Transit System December 10, 2015

**E-1** In response to this comment letter, the Applicant and the County have consulted further with the Metropolitan Transit System (MTS) regarding the number and locations of bus stops proposed as part of the project. The Applicant and the County have agreed to provide one completed bus stop along the project's frontage (referred to as the "nearside" location requested by MTS), as well as design the site plan and roadway improvement plan to allow for the construction of an additional bus stop near the western boundary of the site if MTS determines it is desirable in the future. As described on Final EIR pages S-2 and S-3, the westerly segment of Pecan Park Lane between Rios Canyon Road and Olde Highway 80 would be eliminated with the development of the project. This portion of Pecan Park Lane contains an MTS bus stop (Bus Stop ID: 40234) associated with the east-bound leg of Route 864. The vacation of Pecan Park Lane would result in the relocation of this existing MTS bus stop. The proposed project would include a new (relocated) bus stop along the project frontage along Olde Highway 80, between Project Driveways 1 and 2, as shown on Final EIR Figure 1-4. The proposed bus stop location has been reviewed and accepted by MTS as part of the site plan design and review. The proposed bus stop design will meet all safety standards of MTS and the County.

- E-2** Please refer to response to comment E-1.
- E-3** Please refer to response to comment E-1.
- E-4** Comment noted.

	<b>E-5</b> Comment noted.
--	---------------------------