

OTAY MESA ROAD INTERIM CONCEPTUAL STRIPING PLAN

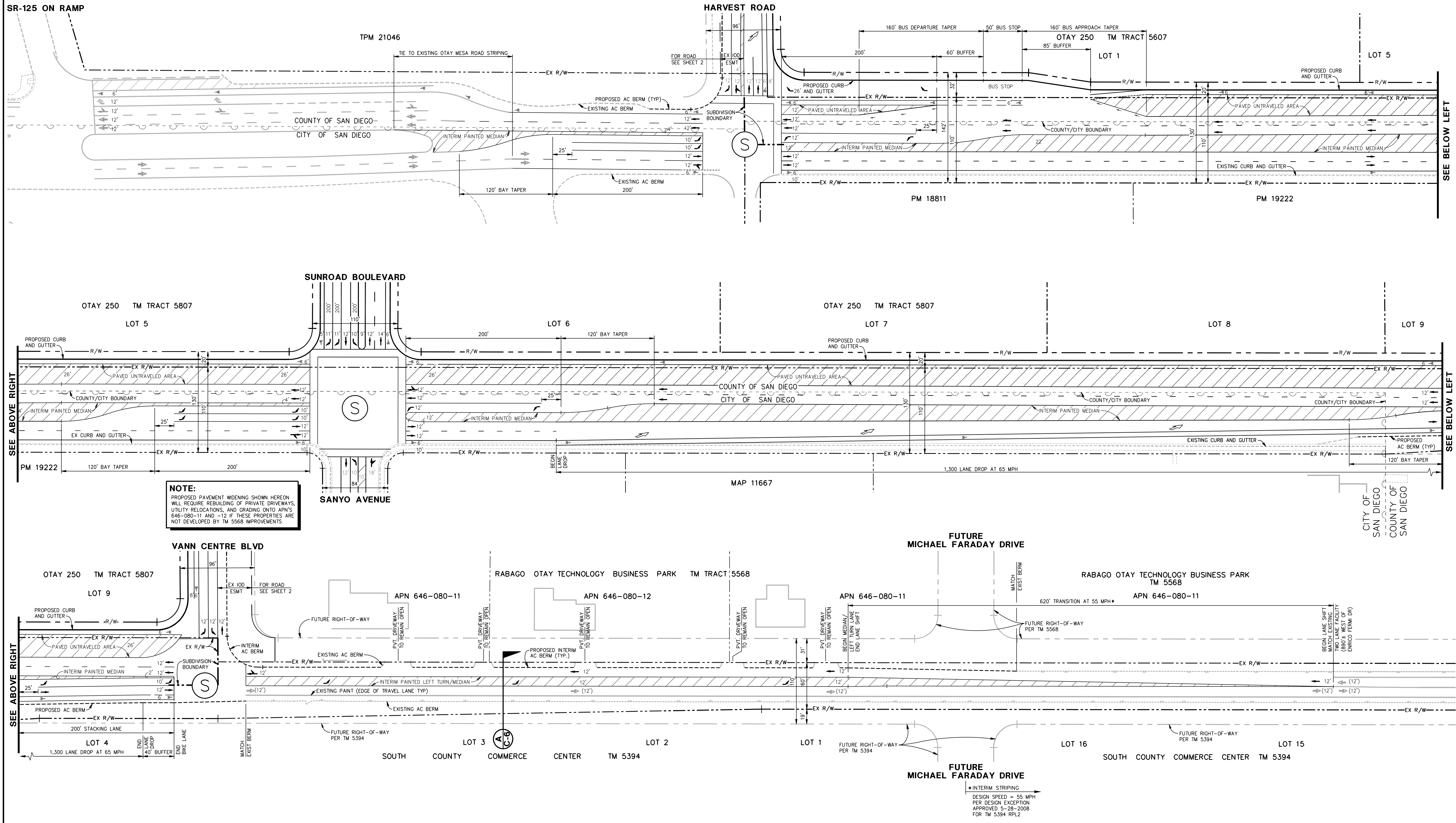

NOTE:
 PROPOSED PAVEMENT WIDENING SHOWN HEREON WILL REQUIRE REBUILDING OF PRIVATE DRIVEWAYS, UTILITY RELOCATIONS, AND GRADING ONTO APN'S 646-080-11 AND -12 IF THESE PROPERTIES ARE NOT DEVELOPED BY TM 5568 IMPROVEMENTS

***NOTE:** EXISTING IMPROVEMENTS ACROSS APN'S 646-080-11 AND 646-080-12 REQUIRE MINIMUM SHOULDER AREA AND 12' (MIN.) MEDIAN

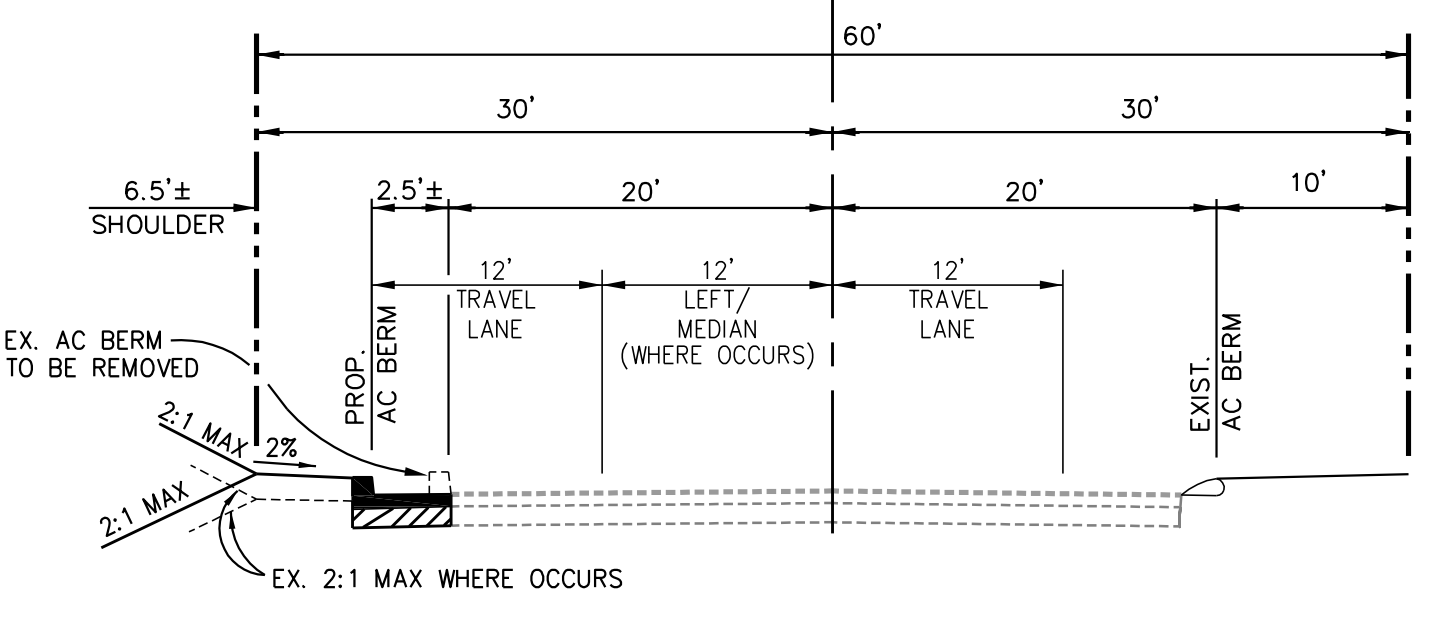

OTAY MESA ROAD - INTERIM SECTION
 NO SCALE
 VANN CENTRE BLVD TO 890± WEST OF ENRICO FERMI DRIVE
 A C-6

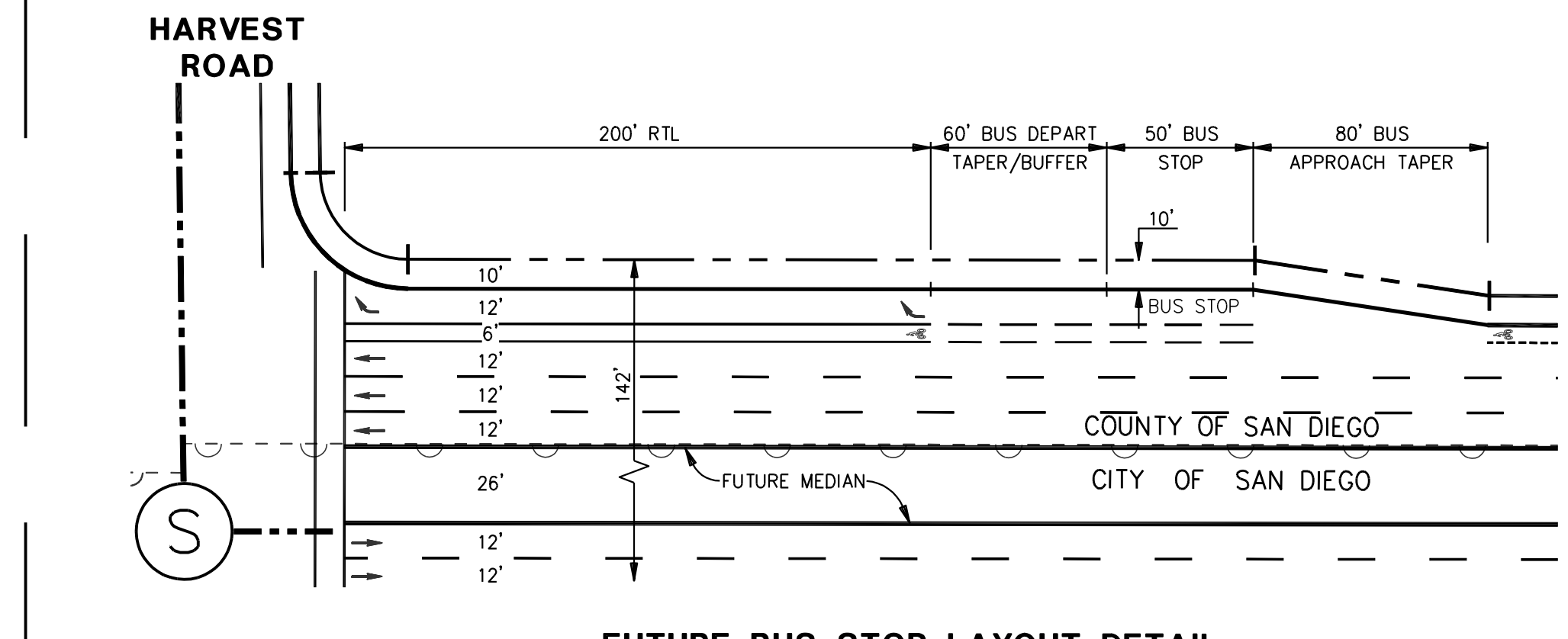

**FUTURE BUS STOP LAYOUT DETAIL
 OTAY MESA ROAD**
 SIX LANE PRIME ARTERIAL
 SCALE: 1"=50'
 B C-6

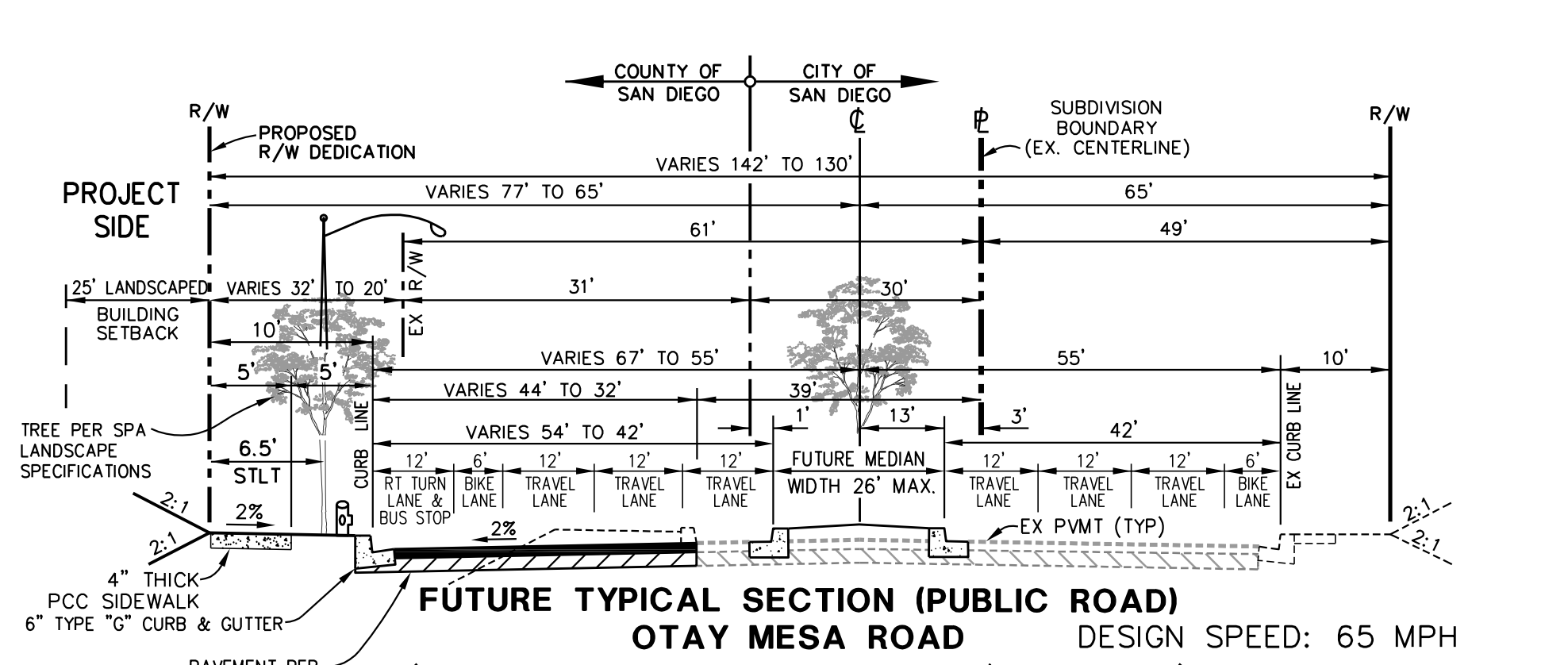

**FUTURE TYPICAL SECTION (PUBLIC ROAD)
 OTAY MESA ROAD**
 DESIGN SPEED: 65 MPH
 (HARVEST ROAD TO SUNROAD BLVD./SANYO AVE.)
 PAVEMENT PER COUNTY REQUIREMENTS
 SPECIFIC PLAN MOBILITY ELEMENT 6-LANE PRIME ARTERIAL (BICYCLE ROUTE)
 (VICINITY OF BUS STOP)
 NO SCALE
 C C-6

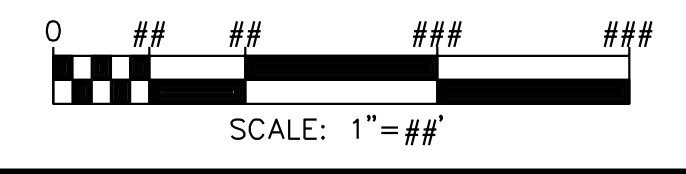

REVISIONS

NO.	DATE	DESCRIPTION	BY

STEVENS CRESTO ENGINEERING, INC.
 CIVIL ENGINEERS - PLANNERS - LAND SURVEYORS
 858.694.5660
 858.694.5660
 SUITE 200
 SAN DIEGO, CA 92123-1352
 www.sceeng.com

REGISTERED PROFESSIONAL ENGINEER
 No. 35502
 Exp. 9-30-17
 CIVIL
 STATE OF CALIFORNIA

INTERIM CONCEPTUAL STRIPING PLAN
OTAY MESA ROAD

COUNTY OF SAN DIEGO TRACT 5607
OTAY 250
COUNTY OF SAN DIEGO, CALIFORNIA

X:\2014\14009\CAD\PRELIM\14009 C-06 STRIPING PLAN.DWG DATE: 12/8/2016 9:47 AM USER: CMB