

1 PUBLIC PROCTOR VALLEY ROAD / CITY OF CHULA VISTA MODIFIED LIGHT COLLECTOR (CCV)
 40 MPH DESIGN SPEED / 20 MPH AT ROUNDABOUT
 NTS
 WAIVERS:
 - MODIFICATIONS TO PARKWAYS AS SHOWN
 - MEDIAN REDUCED TO 4'
 - REDUCE DESIGN SPEED FROM 40 MPH TO 30 MPH (20 MPH)
 - RIGHT OF WAY REDUCED FROM 78' TO 68'

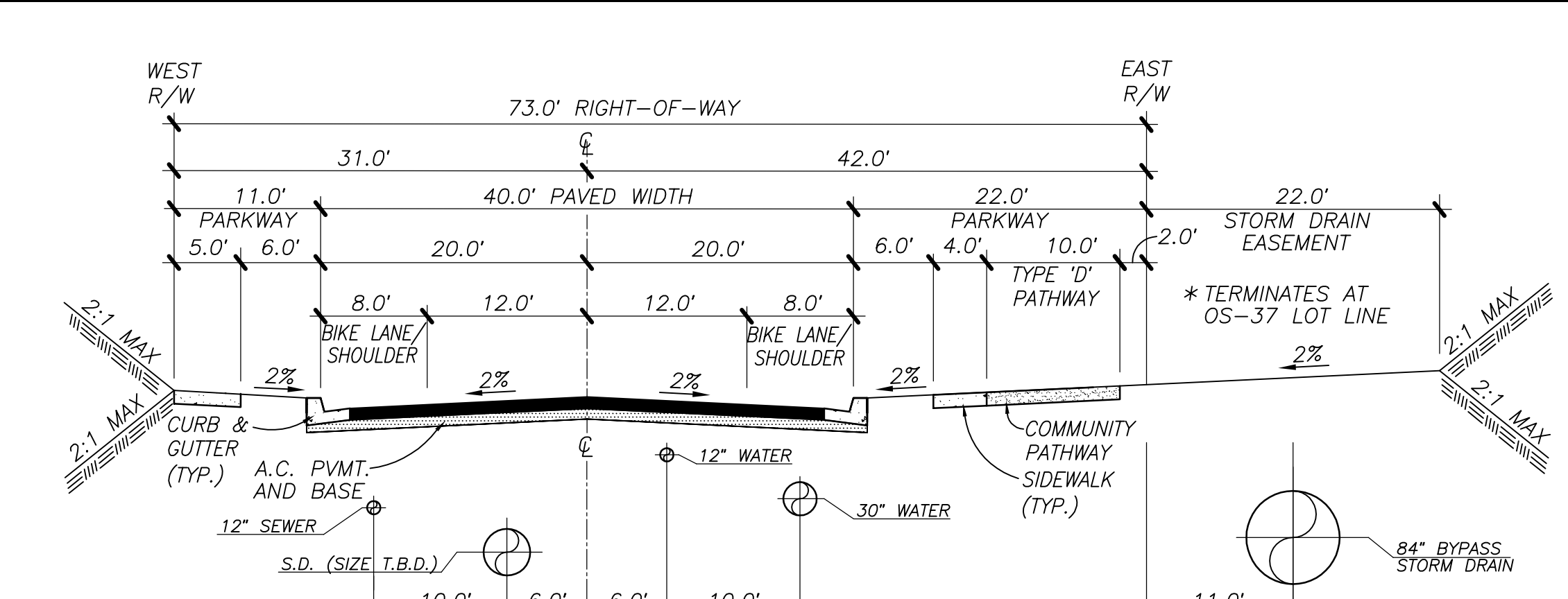

6 PUBLIC PROCTOR VALLEY ROAD MODIFIED LIGHT COLLECTOR (2.2E)
 30 MPH DESIGN SPEED / 20 MPH AT ROUNDABOUT
 NTS
 WAIVERS:
 - MODIFICATIONS TO PARKWAYS AS SHOWN
 - REDUCE DESIGN SPEED FROM 40 MPH TO 30 MPH (20 MPH)
 - RIGHT OF WAY INCREASED FROM 64' TO 72'

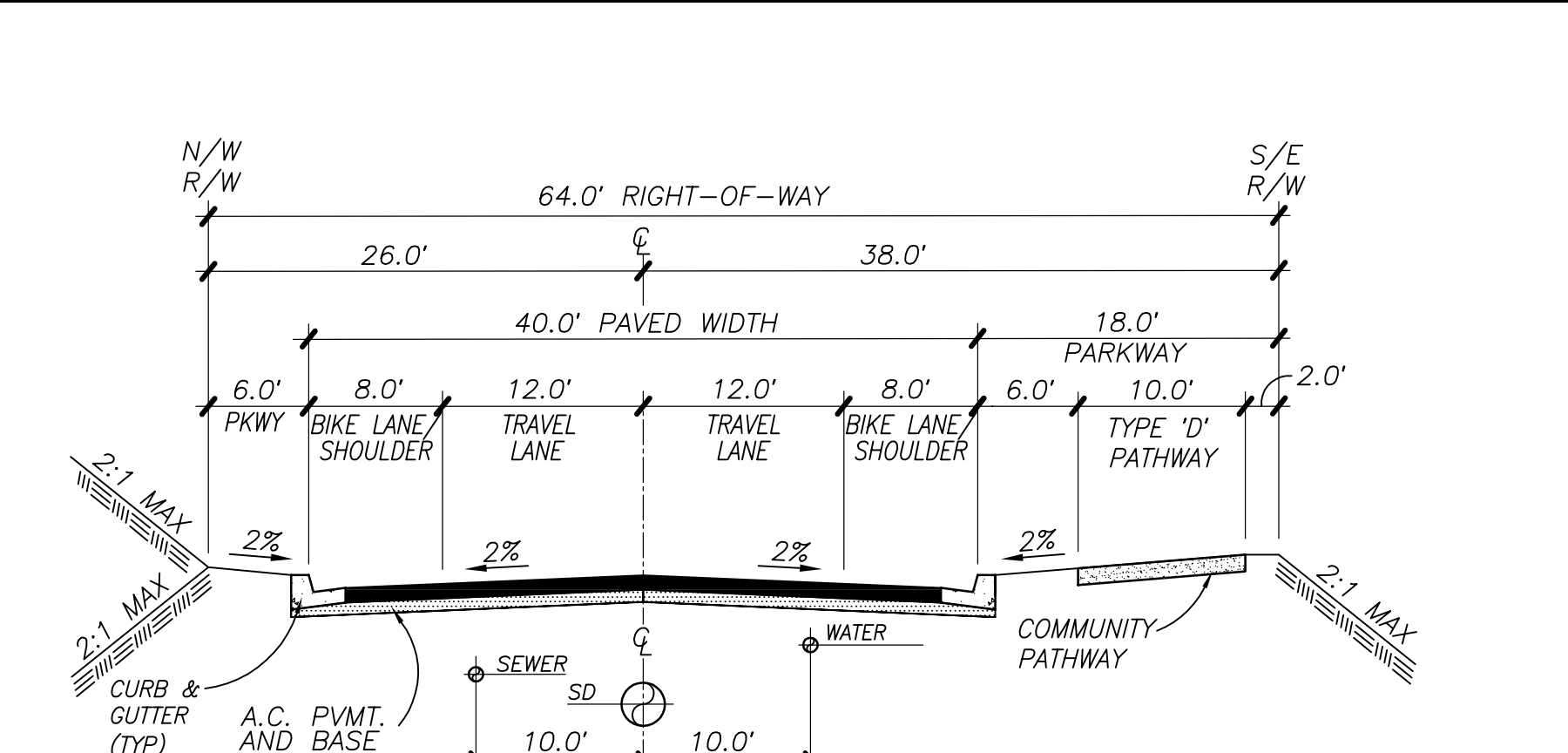

7 PUBLIC PROCTOR VALLEY ROAD MODIFIED LIGHT COLLECTOR (2.2E)
 25 MPH DESIGN SPEED
 NTS
 WAIVERS:
 - MODIFICATIONS TO PARKWAYS AS SHOWN
 - REDUCE DESIGN SPEED FROM 30 MPH TO 25 MPH
 - REDUCE MINIMUM HORIZONTAL CURVE RADIUS FROM 300' TO 200'

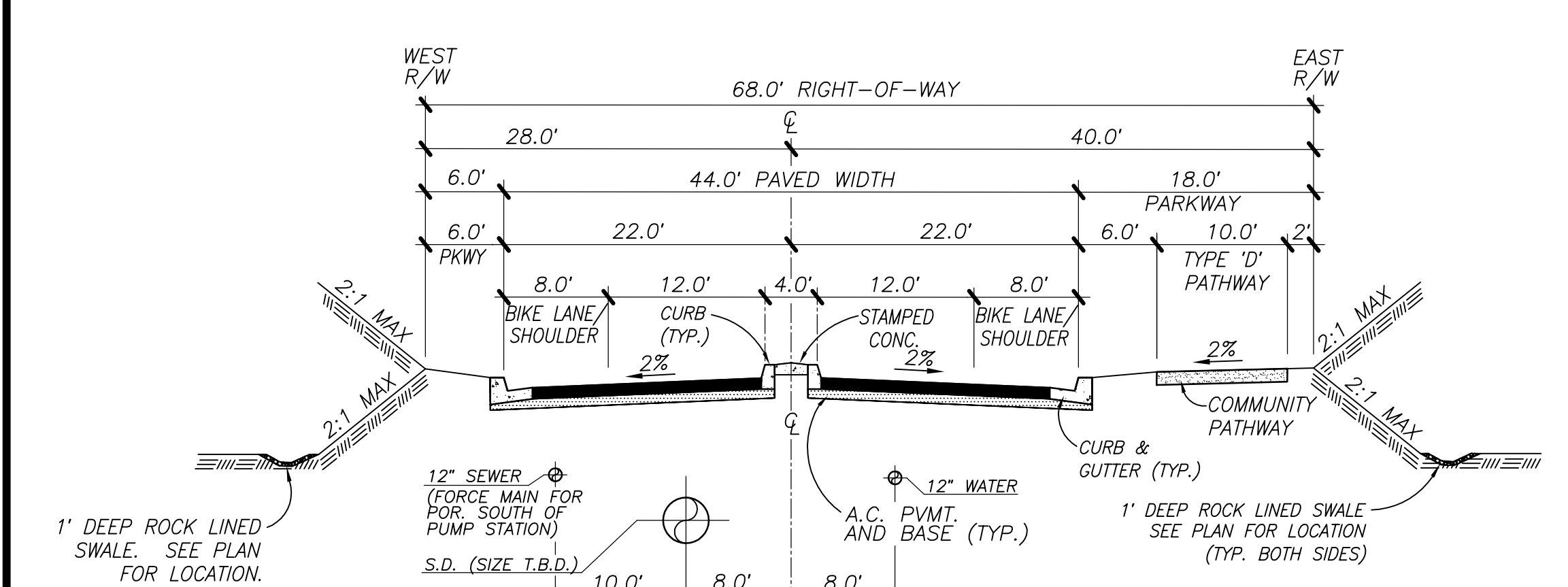

2 PUBLIC PROCTOR VALLEY ROAD MODIFIED LIGHT COLLECTOR (2.2A)
 40 MPH DESIGN SPEED
 NTS
 WAIVERS:
 - MODIFICATIONS TO PARKWAYS AS SHOWN
 - MEDIAN REDUCED TO 4'
 - RIGHT OF WAY REDUCED FROM 78' TO 68'

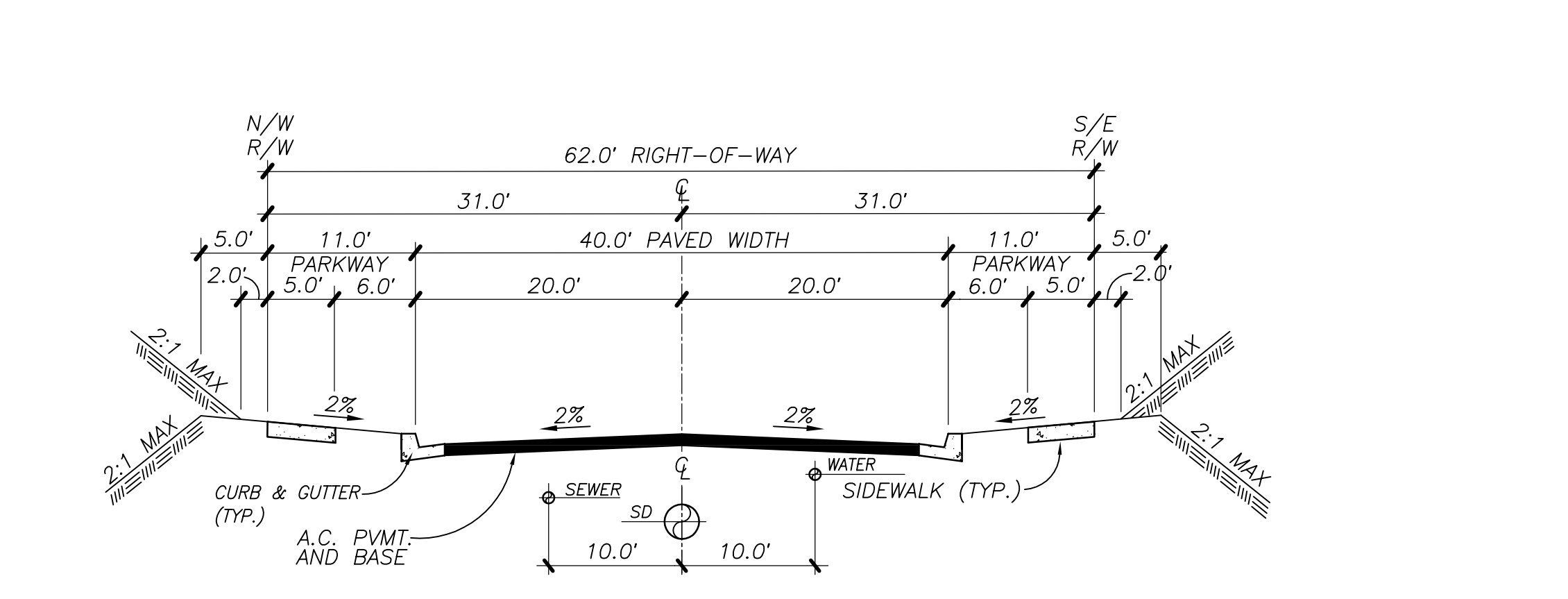

8A PRIVATE MODIFIED RESIDENTIAL COLLECTOR
 25 MPH DESIGN SPEED
 NTS
 WAIVERS:
 - REDUCE DESIGN SPEED FROM 30 MPH TO 25 MPH
 - DUE TO STEEP TERRAIN AND AN EFFORT TO MINIMIZE IMPACTS TO THE SURROUNDING MSCP PRESERVE, A MINIMUM INTERSECTION SPACING OF 150' IS REQUESTED IN LIEU OF 200'
 - REDUCE MINIMUM HORIZONTAL CURVE RADIUS FROM 300' TO 200'
 - MODIFICATIONS TO PARKWAYS AS SHOWN
 - RIGHT OF WAY INCREASED FROM 60' TO 62'

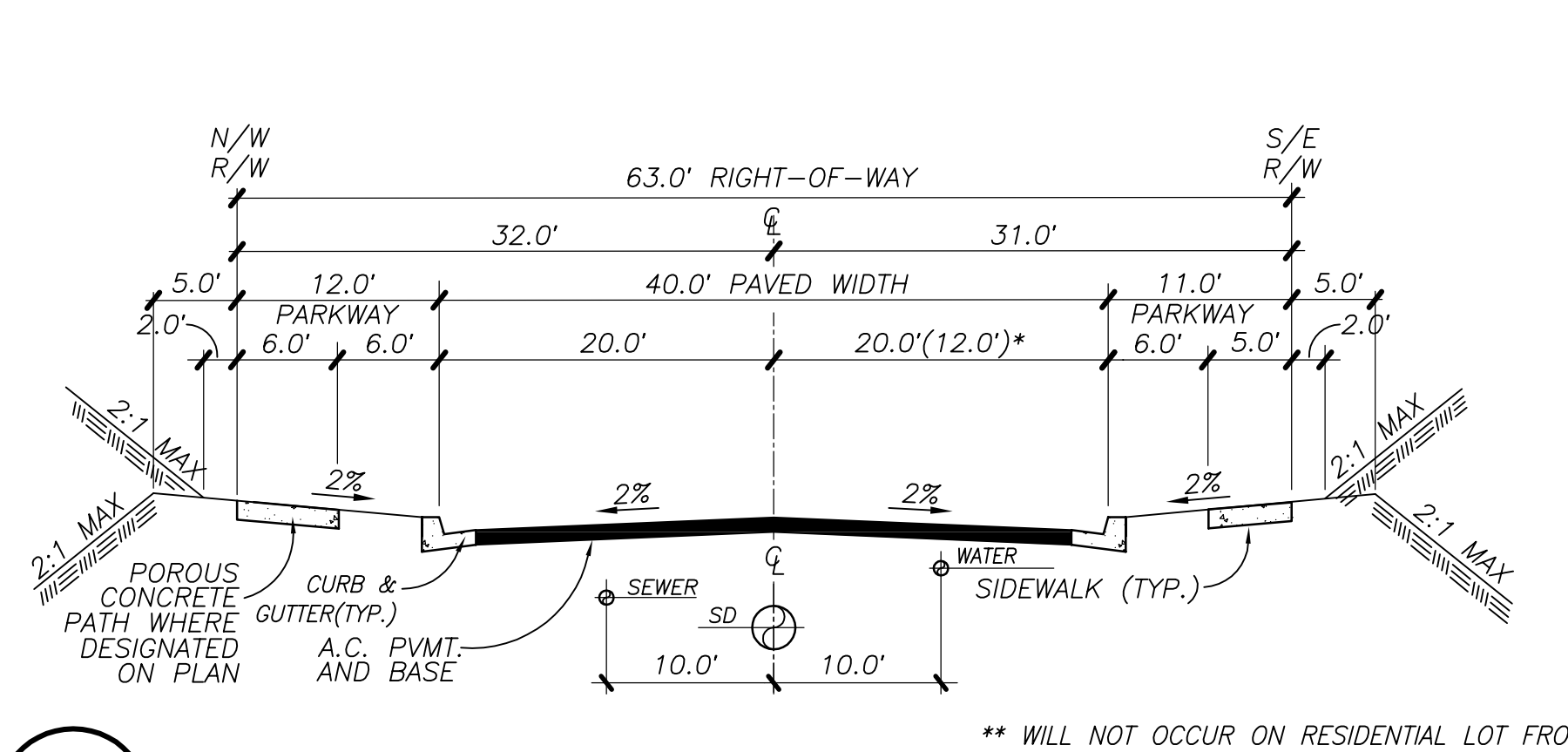

8B PRIVATE MODIFIED RESIDENTIAL COLLECTOR
 25 MPH DESIGN SPEED
 NTS
 WAIVERS:
 - REDUCE DESIGN SPEED FROM 30 MPH TO 25 MPH
 - DUE TO STEEP TERRAIN AND AN EFFORT TO MINIMIZE IMPACTS TO THE SURROUNDING MSCP PRESERVE, A MINIMUM INTERSECTION SPACING OF 150' IS REQUESTED IN LIEU OF 200'
 - REDUCE MINIMUM HORIZONTAL CURVE RADIUS FROM 300' TO 200'
 - MODIFICATIONS TO PARKWAYS AS SHOWN
 - RIGHT OF WAY INCREASED FROM 60' TO 63'

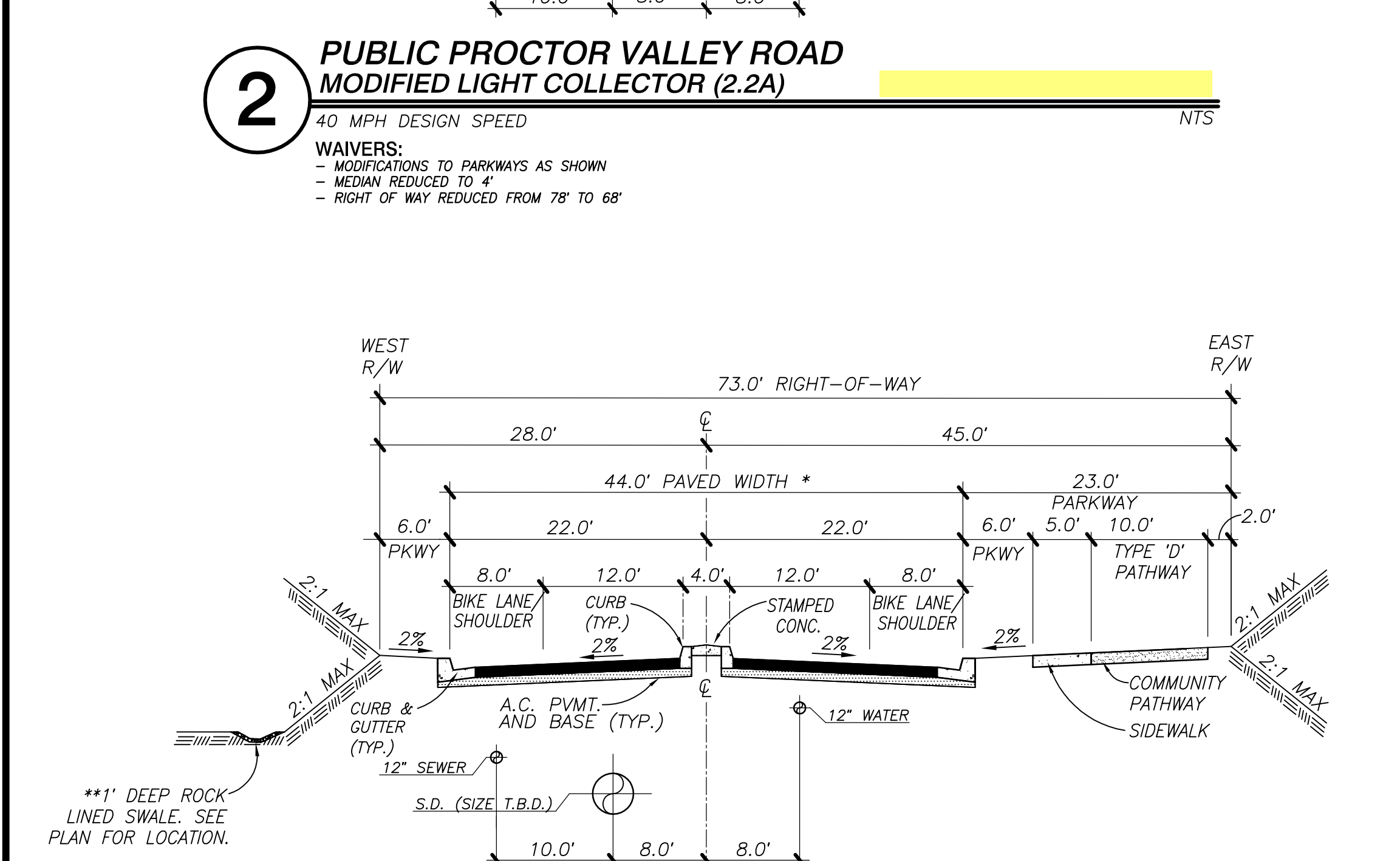

3 PUBLIC PROCTOR VALLEY ROAD MODIFIED LIGHT COLLECTOR (2.2A)
 30 MPH DESIGN SPEED / 20 MPH AT ROUNDABOUT
 NTS
 WAIVERS:
 - MODIFICATIONS TO PARKWAYS AS SHOWN
 - MEDIAN REDUCED TO 4'
 - REDUCE DESIGN SPEED FROM 40 MPH TO 30 MPH (20 MPH)
 - RIGHT OF WAY REDUCED FROM 78' TO 73'

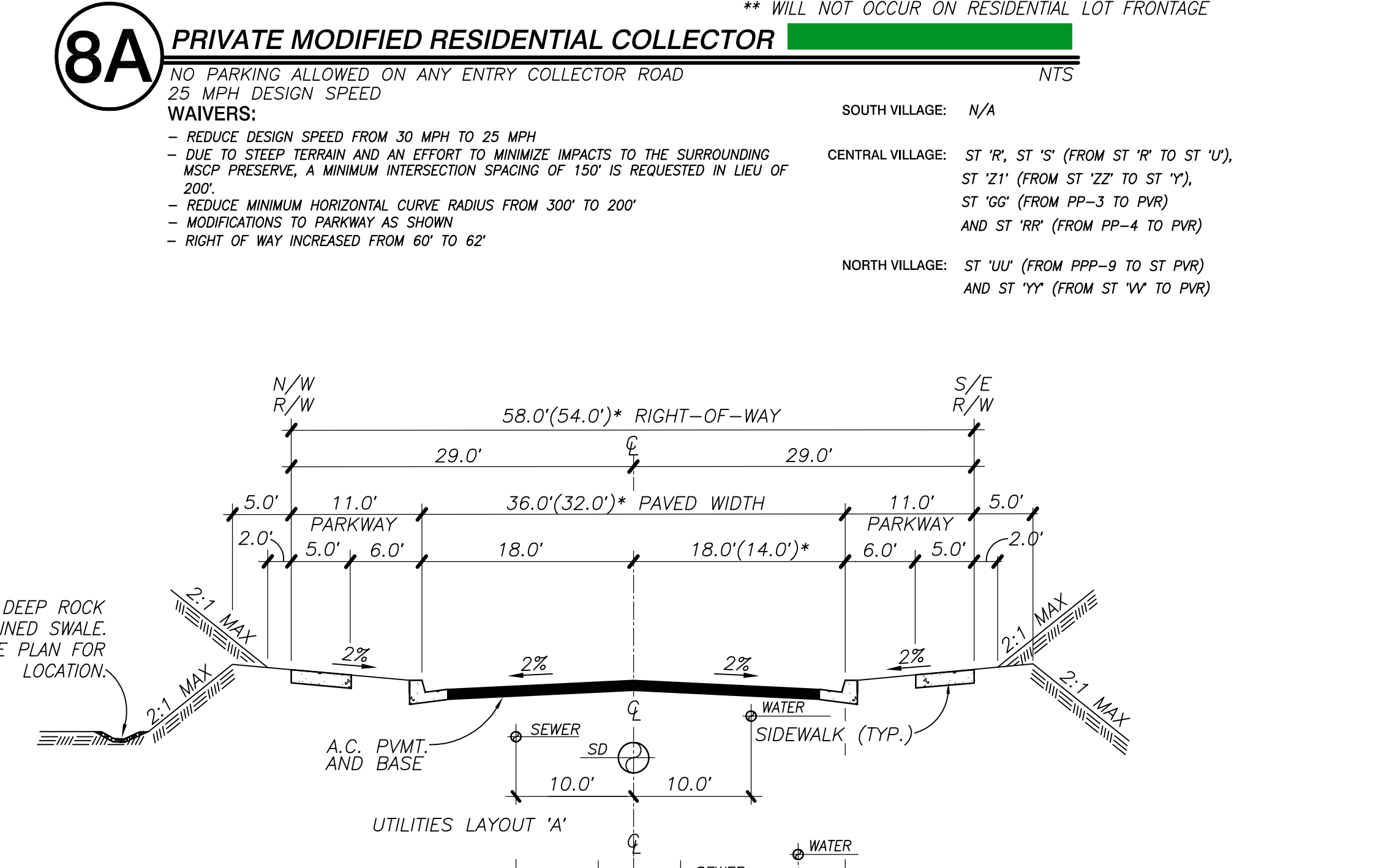

9A PRIVATE MODIFIED RESIDENTIAL ROAD
 25 MPH DESIGN SPEED
 NTS
 WAIVERS:
 - REDUCE DESIGN SPEED FROM 30 MPH TO 25 MPH
 - DUE TO STEEP TERRAIN AND AN EFFORT TO MINIMIZE IMPACTS TO THE SURROUNDING MSCP PRESERVE, A MINIMUM INTERSECTION SPACING OF 150' IS REQUESTED IN LIEU OF 200'
 - MODIFICATIONS TO PARKWAYS AS SHOWN
 - REDUCE MINIMUM HORIZONTAL CURVE RADIUS FROM 200' TO 160'
 - RIGHT OF WAY INCREASED FROM 56' TO 58'
 * PARKING CAN BE ELIMINATED ON ONE SIDE IF ROAD IS NON-LOADED. SEE PLAN FOR LOCATIONS.

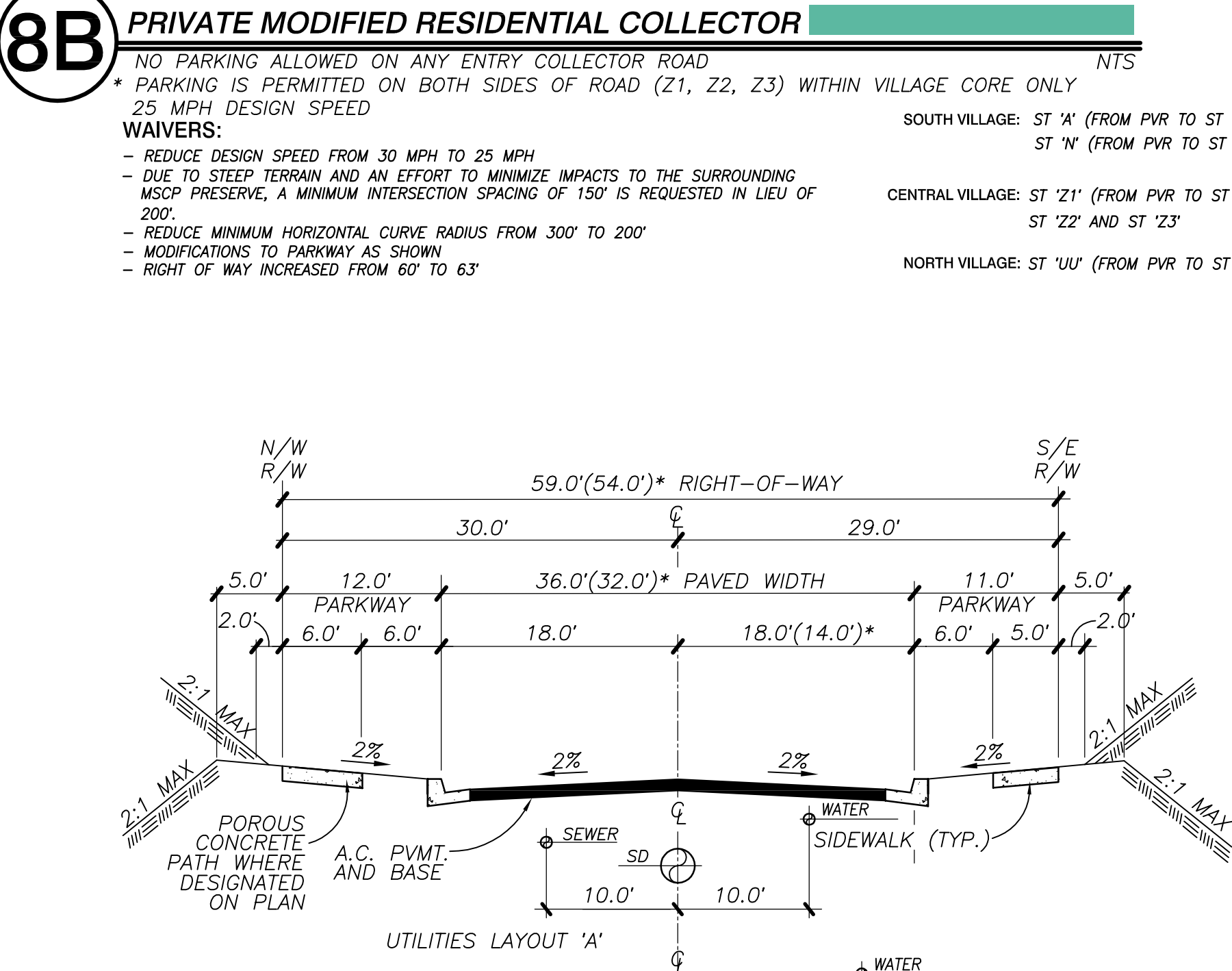

9B PRIVATE MODIFIED RESIDENTIAL ROAD
 25 MPH DESIGN SPEED
 NTS
 WAIVERS:
 - REDUCE DESIGN SPEED FROM 30 MPH TO 25 MPH
 - DUE TO STEEP TERRAIN AND AN EFFORT TO MINIMIZE IMPACTS TO THE SURROUNDING MSCP PRESERVE, A MINIMUM INTERSECTION SPACING OF 150' IS REQUESTED IN LIEU OF 200'
 - MODIFICATIONS TO PARKWAYS AS SHOWN
 - REDUCE MINIMUM HORIZONTAL CURVE RADIUS FROM 200' TO 160'
 - RIGHT OF WAY INCREASED FROM 56' TO 59'
 * PARKING CAN BE ELIMINATED ON ONE SIDE IF ROAD IS NON-LOADED. SEE PLAN FOR LOCATIONS.

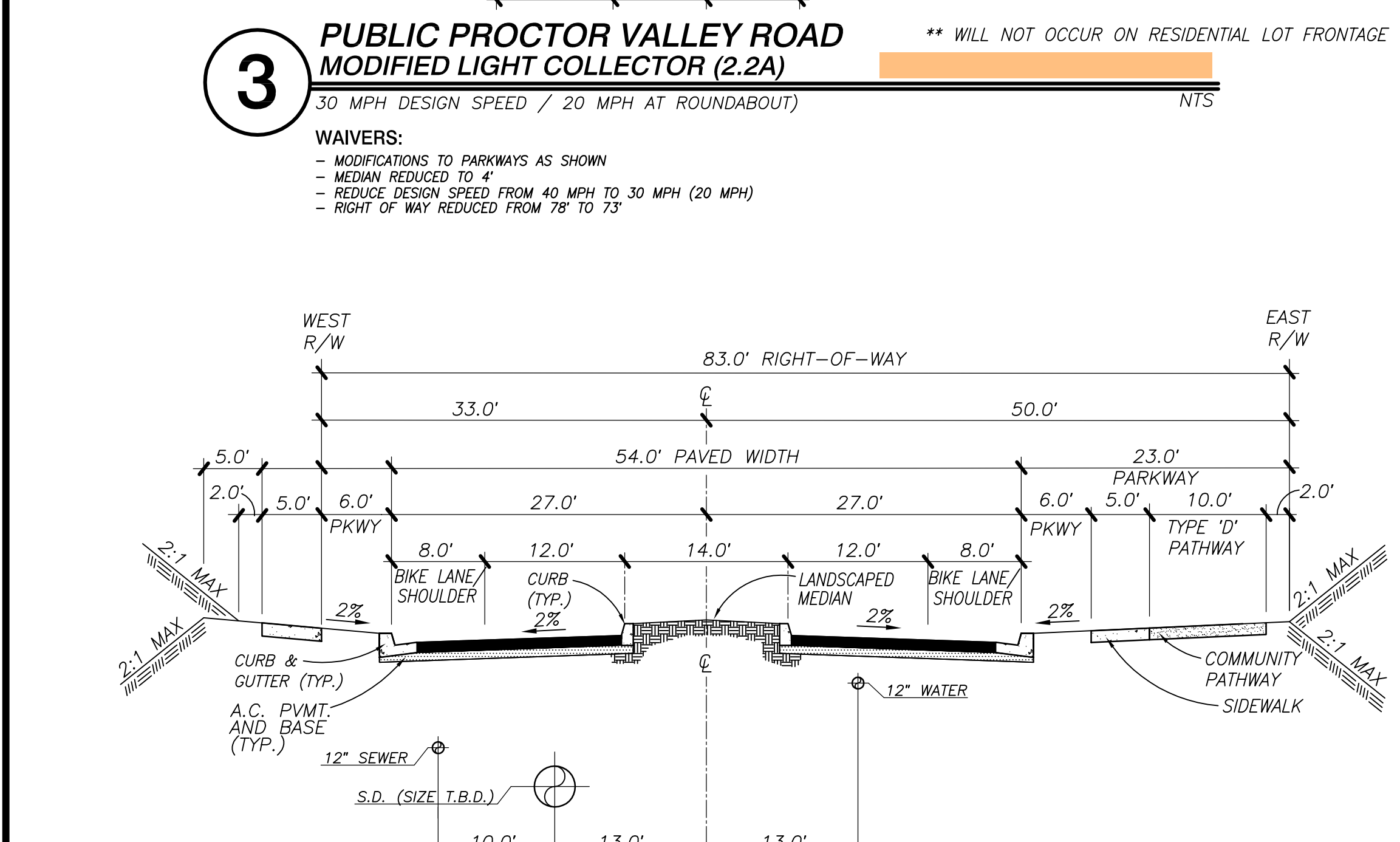

4 PUBLIC PROCTOR VALLEY ROAD MODIFIED LIGHT COLLECTOR (2.2A)
 30 MPH DESIGN SPEED / 20 MPH AT ROUNDABOUT
 NTS
 WAIVERS:
 - MODIFICATIONS TO PARKWAYS AS SHOWN
 - REDUCE DESIGN SPEED FROM 40 MPH TO 30 MPH (20 MPH)
 - RIGHT OF WAY INCREASED FROM 78' TO 83'

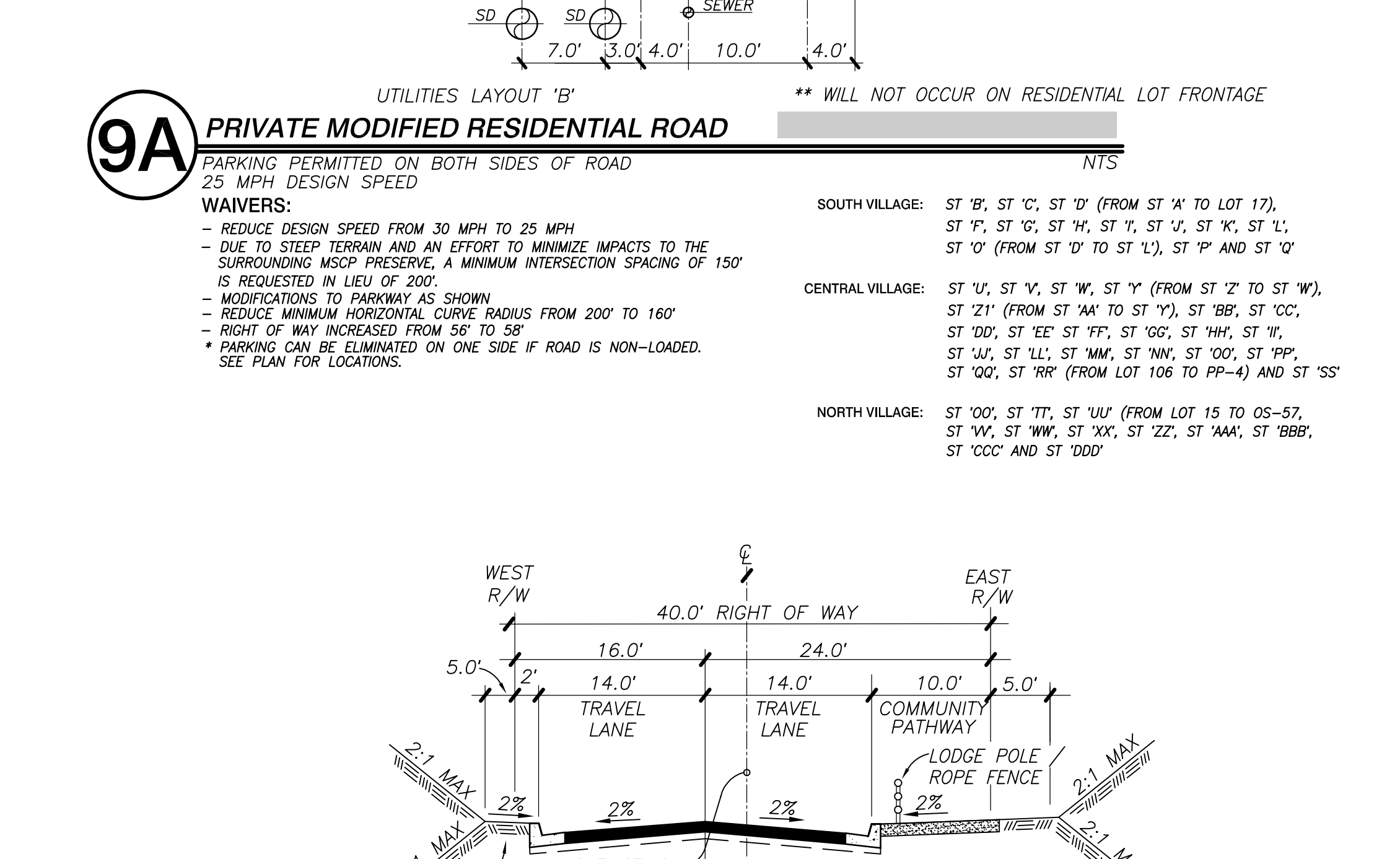

10 PUBLIC PROCTOR VALLEY ROAD MODIFIED LIGHT COLLECTOR (2.2F)
 40 MPH DESIGN SPEED
 NTS
 WAIVERS:
 - MODIFICATION/ELIMINATION OF PARKWAYS AS SHOWN
 - RIGHT OF WAY REDUCED FROM 52' TO 40'

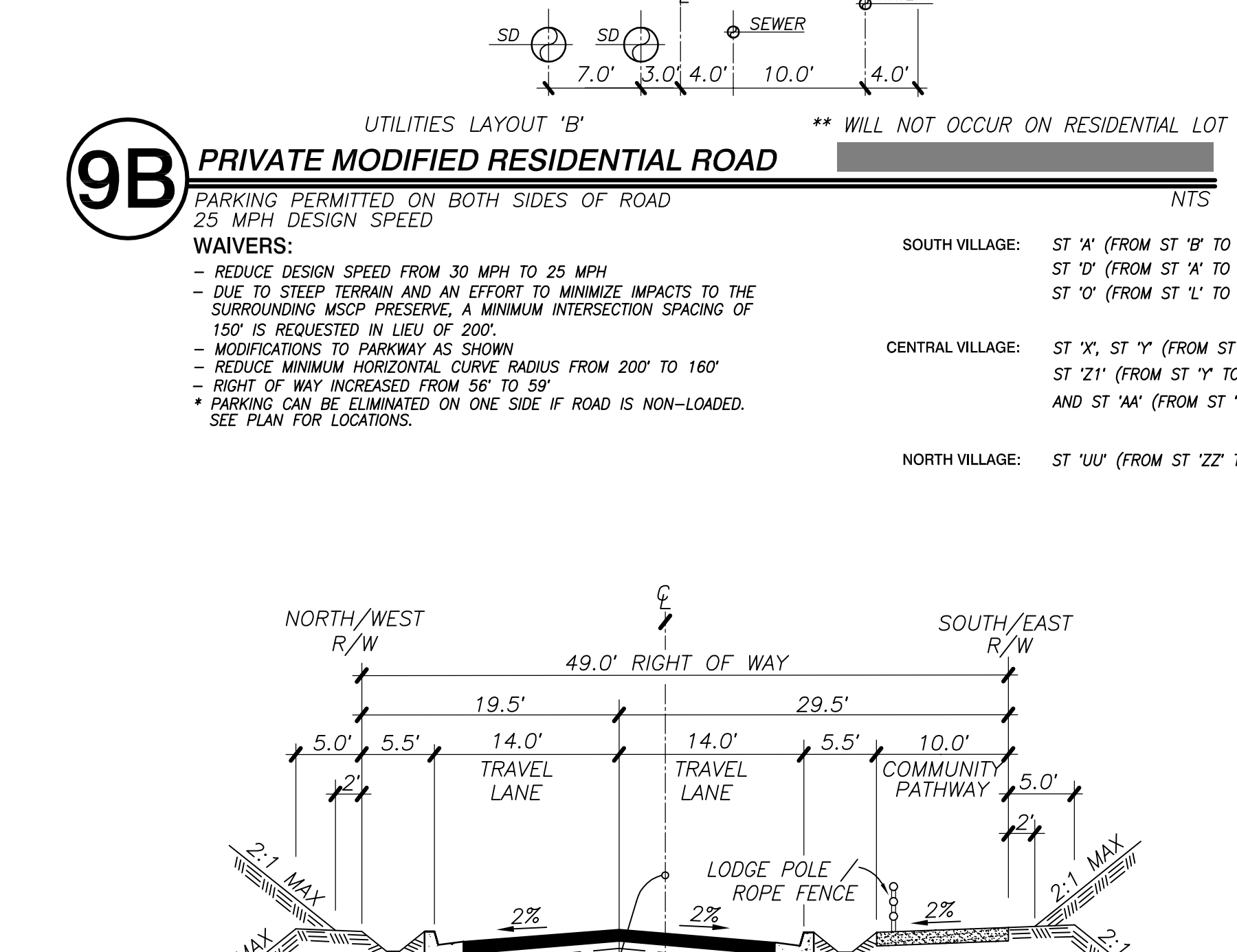

10A PUBLIC PROCTOR VALLEY ROAD MODIFIED LIGHT COLLECTOR (2.2F)
 40 MPH DESIGN SPEED
 NTS
 WAIVERS:
 - MODIFICATION/ELIMINATION OF PARKWAYS AS SHOWN
 - RIGHT OF WAY REDUCED FROM 52' TO 49'

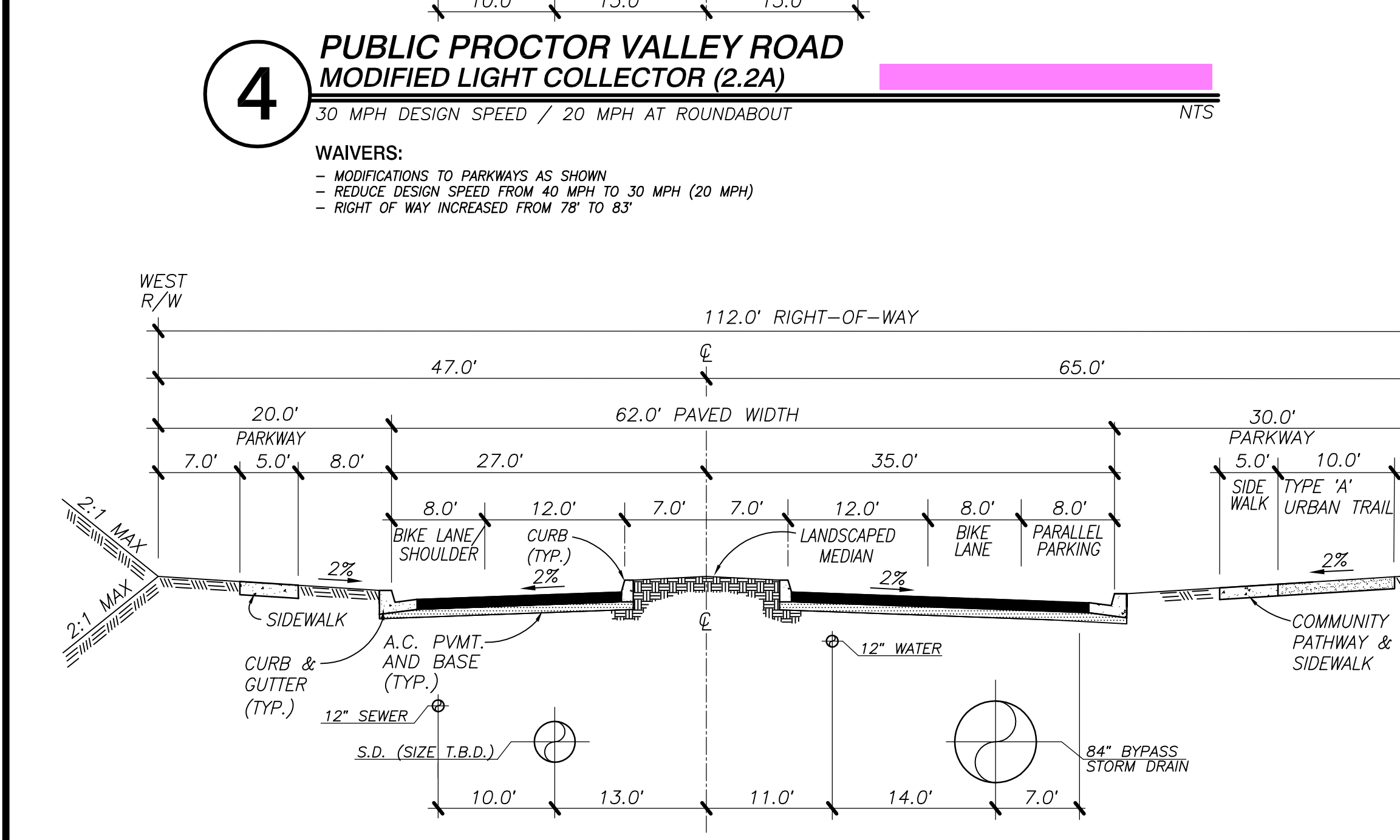

5 PUBLIC PROCTOR VALLEY ROAD MODIFIED LIGHT COLLECTOR (2.2A)
 30 MPH DESIGN SPEED / 20 MPH AT ROUNDABOUT
 NTS
 WAIVERS:
 - MODIFICATIONS TO PARKWAYS AS SHOWN
 - REDUCE DESIGN SPEED FROM 40 MPH TO 30 MPH (20 MPH)
 - RIGHT OF WAY INCREASED FROM 78' TO 112'

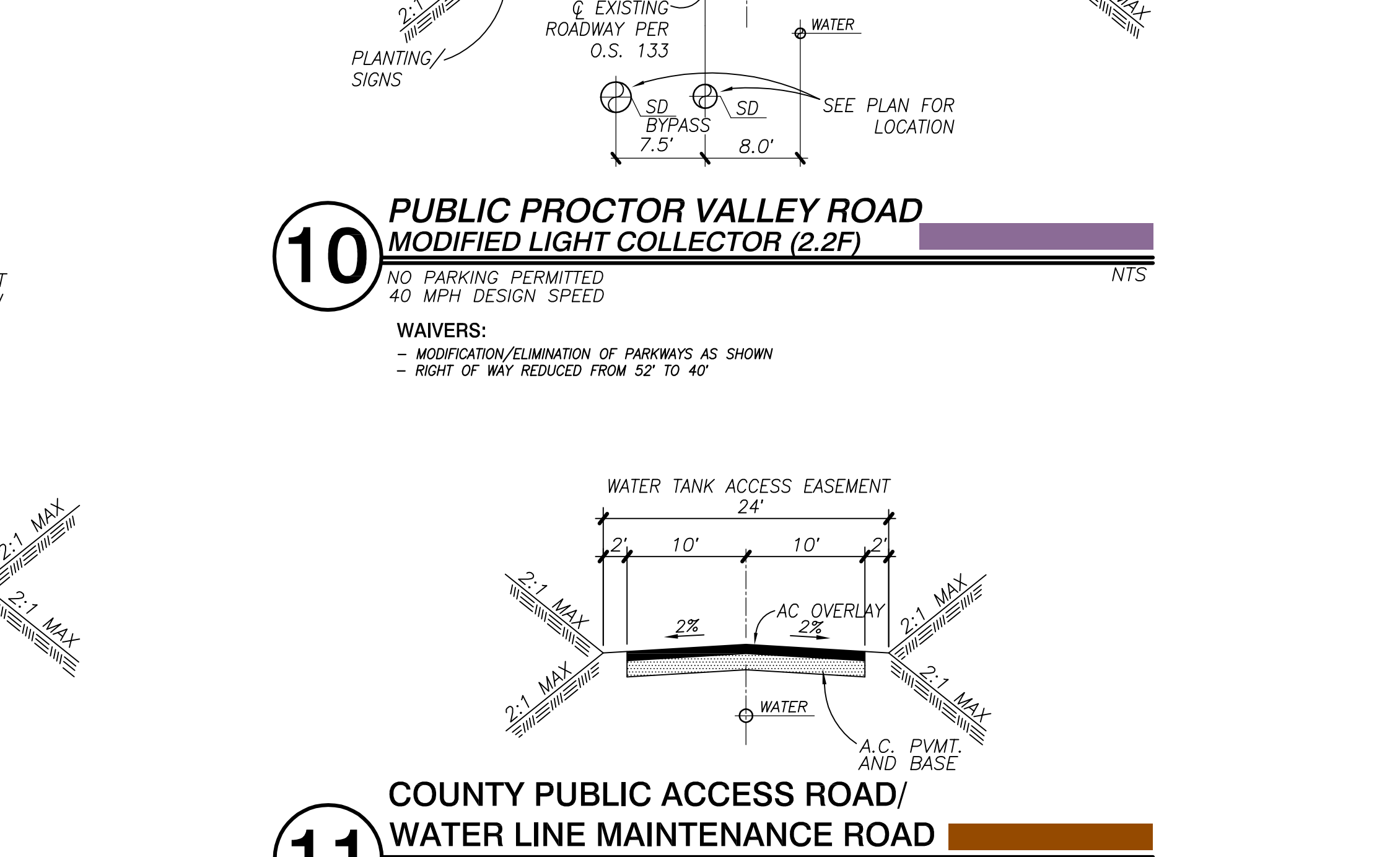

11 COUNTY PUBLIC ACCESS ROAD / WATER LINE MAINTENANCE ROAD
 25 MPH DESIGN SPEED
 NTS

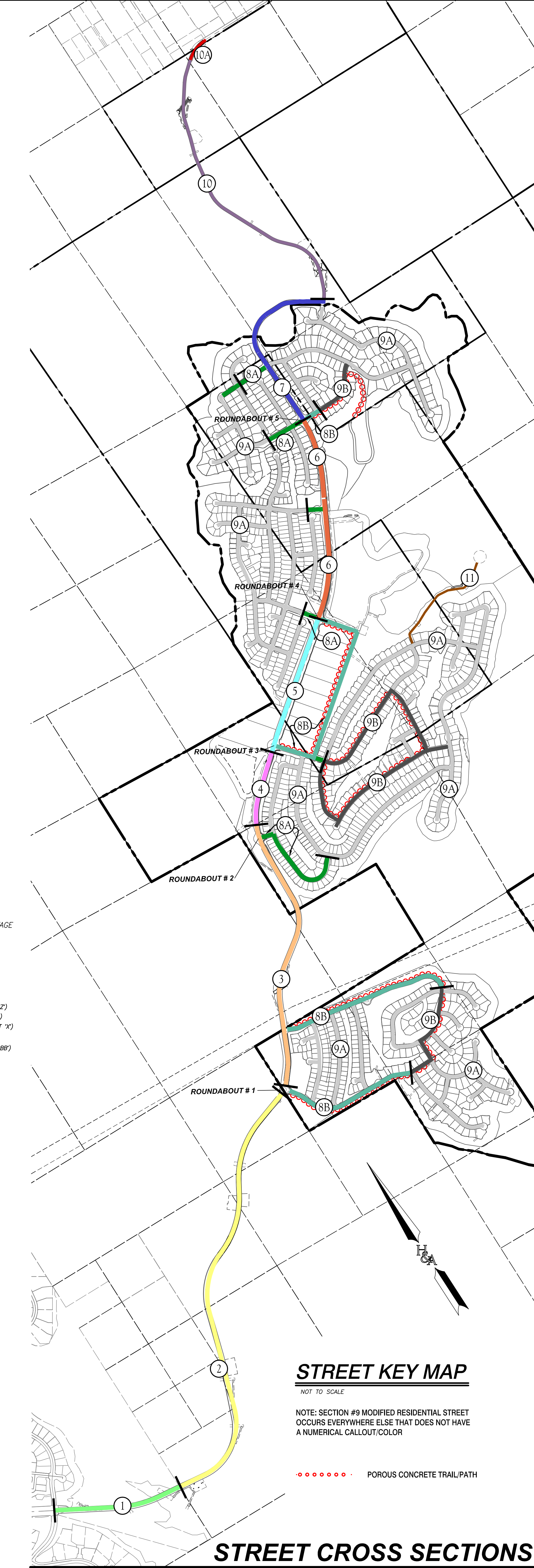

STREET KEY MAP

NOT TO SCALE
 NOTE: SECTION #9B MODIFIED RESIDENTIAL STREET OCCURS EVERYWHERE ELSE THAT DOES NOT HAVE A NUMERICAL CALLOUT/COLOR

..... POROUS CONCRETE TRAIL PATH

STREET CROSS SECTIONS

PREPARED BY: HUNSAKER & ASSOCIATES PLANNING 9700 Weldon Street ENGINEERING San Diego, CA 92121 SURVEYING PH080505-6500 - PH080505-5114	PRELIMINARY GRADING PLAN OTAY RANCH VILLAGE 14 LAND EXCHANGE ALTERNATIVE County Of San Diego, California		SHEET 3 OF 16
	R:\1235\4\Pin\TM - Grading Plan (based on Land Swap)\Village 14 - PRELIM GRADING - SH 03.dwg[1/20-2018/09/30]		06/20 16247-37