

From: [Avalos, Tona](#)
To: ["Chenoweth, William"](#); [Patrick Brown](#); [Brown, Bronwyn](#); [Bossu, David](#)
Cc: [David Hochart](#); [Erlin Worthington](#); [George Gunnoe](#); [Harris, Susan](#); [Sinsay, Edwin M](#)
Subject: RE: JVR Solar - Centerline Separation at Carrizo Gorge Road
Date: Friday, February 01, 2019 1:55:30 PM

The west side driveway is what we are looking for, but the east side driveway cannot cross the "60' County of San Diego Easement" as shown. We are suggesting that the project driveway connect to the 60' public road easement, then connect to Carrizo Gorge Road, something similar to the orange line in the image below.

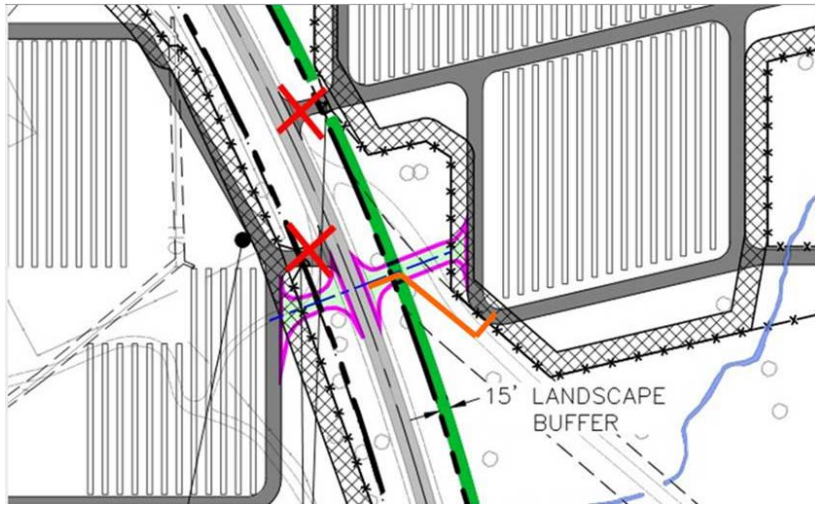

If the driveway aligns with the public road easement across Carrizo Gorge Road, this would eliminate the need for a Design Exception Request.

For Old Highway 80, if the driveways align with each other and are 300' from the centerline of any other driveway, then a DER will not be needed.

If you have any other questions, please let me know.

Thanks,
Tona

From: Chenoweth, William [mailto:william.chenoweth@kimley-horn.com]
Sent: Friday, February 01, 2019 1:08 PM
To: Patrick Brown <Patrick.Brown@baywa-re.com>; Brown, Bronwyn <Bronwyn.Brown@sdcounty.ca.gov>; Bossu, David <david.bossu@kimley-horn.com>
Cc: David Hochart <dhochart@dudek.com>; Erlin Worthington <eworthington@dudek.com>; George Gunnoe <George.Gunnoe@baywa-re.com>; Harris, Susan <Susan.Harris@sdcounty.ca.gov>; Avalos, Tona <Tona.Avalos@sdcounty.ca.gov>; Sinsay, Edwin M <Edwin.Sinsay@sdcounty.ca.gov>
Subject: RE: JVR Solar - Centerline Separation at Carrizo Gorge Road

Hi Tona,

I think I understand what you mean – are you requesting the layouts match the magenta outlines with green hatch pictured below? Gates would be installed outside of County R/W and easements and all existing driveways to be abandoned would file for relinquishment of access.

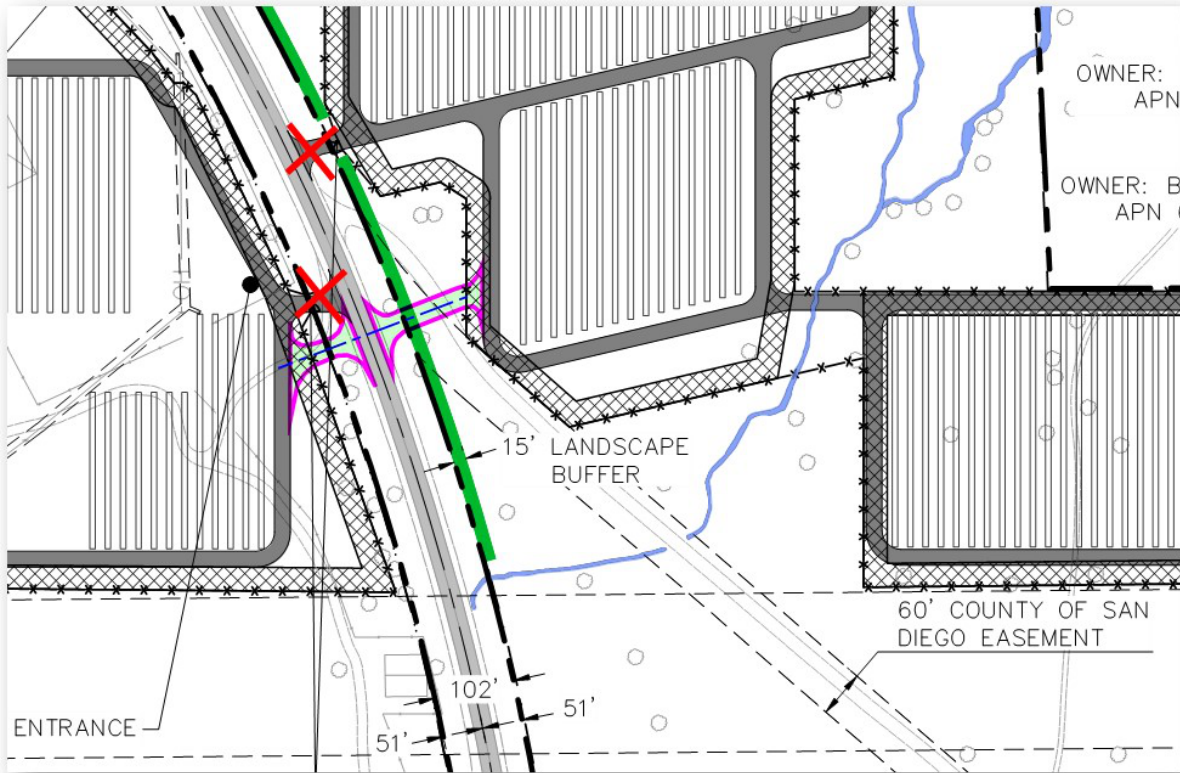

Similarly, along Old Hwy 80, may we relocate our driveways to be 300' from C/L of all existing driveways but align with each-other across the street? See sketch below for example.

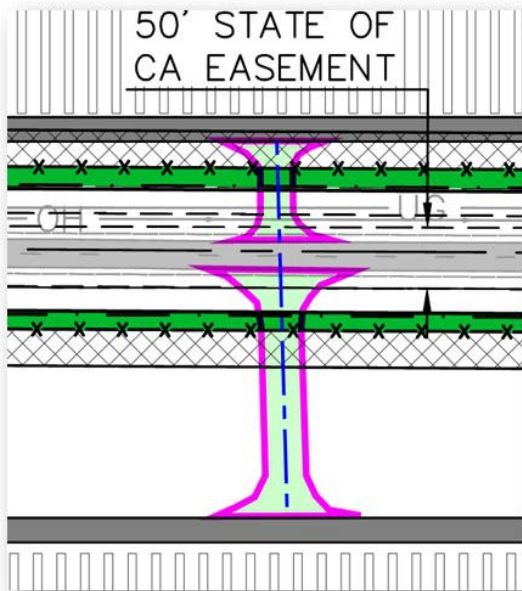

Will both of these designs eliminate a need for design exception requests?

Thanks,

William Chenoweth
 Kimley-Horn | 765 The City Drive, Suite 200, Orange, CA 92868
 Direct: 714 705 1320 | Mobile: 562 522 3746 | www.kimley-horn.com

From: Patrick Brown <Patrick.Brown@baywa-re.com>
Sent: Tuesday, January 29, 2019 4:58 PM
To: Brown, Bronwyn <Bronwyn.Brown@sdcounty.ca.gov>; Chenoweth, William <william.chenoweth@kimley-horn.com>; Bossu, David <david.bossu@kimley-horn.com>
Cc: David Hochart <dhochart@dudek.com>; Erlin Worthington <eworthington@dudek.com>; George Gunnoe <George.Gunnoe@baywa-re.com>; Harris, Susan

<Susan.Harris@sdcounty.ca.gov>; Avalos, Tona <Tona.Avalos@sdcounty.ca.gov>; Sinsay, Edwin M <Edwin.Sinsay@sdcounty.ca.gov>

Subject: Re: JVR Solar - Centerline Separation at Carrizo Gorge Road

Adding in our engineers.

On Jan 29, 2019, at 4:21 PM, Brown, Bronwyn <Bronwyn.Brown@sdcounty.ca.gov> wrote:

Hi there,

Please see email below. If you want to add this item to the Agenda for next week for our weekly meeting for further discussion.

Thanks.

From: Avalos, Tona <Tona.Avalos@sdcounty.ca.gov>

Sent: Tuesday, January 29, 2019 4:18 PM

To: Brown, Bronwyn <Bronwyn.Brown@sdcounty.ca.gov>

Cc: Sinsay, Edwin M <Edwin.Sinsay@sdcounty.ca.gov>

Subject: JVR Solar - Centerline Separation at Carrizo Gorge Road

Hi Bronwyn,

I discussed the issue that came up at last week's meeting regarding the centerline separation at Carrizo Gorge Road with Zoubir Ouadah, the Traffic Engineer. Since there is an existing public road easement near the proposed driveways as well, he suggested that the proposed driveway access onto the east side of Carrizo Gorge Road be removed, and the project can take access onto the public road easement which connects to Carrizo Gorge Road. Then the proposed driveway accessing the west side of Carrizo Gorge Road can be realigned to align with the public road easement, and a Design Exception Request would not be allowed.

Sight Distance Certification would still be required at both proposed driveway access points.

Thank you,

Tona Avalos, PE

Civil Engineer

[Planning & Development Services](#)

County of San Diego

tona.avalos@sdcounty.ca.gov

(858) 495-5284