

From: [Cruikshank, Tatsiana](#)
To: [Avalos, Tona](#)
Cc: [Chenoweth, William](#); [Bossu, David](#)
Subject: RE: JVR Energy Park (PDS2018-MUP-18-022)
Date: Tuesday, May 25, 2021 5:56:38 PM
Attachments: [image002.png](#)

Hey Tona,

We'd like to set up a call with the traffic engineer to discuss the driveway turnaround and taper requirements. Is there any availability this Thursday to discuss these topics?

Best Regards,
Tanya

Tatsiana Cruickshank
Kimley-Horn | 1100 W Town and Country Road, Suite 700, Orange, CA 92868
Direct: 714-705-1338 | www.kimley-horn.com

From: Avalos, Tona <Tona.Avalos@sdcounty.ca.gov>
Sent: Monday, December 14, 2020 11:42 AM
To: Cruickshank, Tatsiana (Bondar) <Tatsiana.Cruikshank@kimley-horn.com>
Cc: Chenoweth, William <william.chenoweth@kimley-horn.com>; Bossu, David <david.bossu@kimley-horn.com>
Subject: RE: JVR Energy Park (PDS2018-MUP-18-022)

Hi Tanya,
I'm not sure exactly which standard you are referring to? Please see attached for the Standard Drawings for driveways. Since many of these designs are for sidewalks, you would probably have to modify one of the designs since sidewalk is not required for the project. A maximum width of 30' is allowed for commercial driveways. The driveway standard would apply at the ultimate pavement location, with tapers to the existing pavement. These items would have to be discussed with the Traffic Engineer, if you want to deviate from any standards.
Thanks,
Tona

From: Bondar, Tatsiana <Tatsiana.Bondar@kimley-horn.com>
Sent: Thursday, December 10, 2020 1:36 PM
To: Avalos, Tona <Tona.Avalos@sdcounty.ca.gov>
Cc: Chenoweth, William <william.chenoweth@kimley-horn.com>; Bossu, David <david.bossu@kimley-horn.com>
Subject: RE: JVR Energy Park (PDS2018-MUP-18-022)

Hey Tona,

Hope you're doing well and staying safe.

I had a quick question I was hoping you'd be able to help answer for me. The driveway entrance off of Carrizo Gorge Road that is being used to access the SDGE switchyard is a 30' wide road and has a proposed driveway radius of 50'. The County standards shows 24' wide and 30' radius for the typical driveway entrances. I just want to confirm that it is acceptable to exceed those dimensions, correct? Hope to hear back soon.

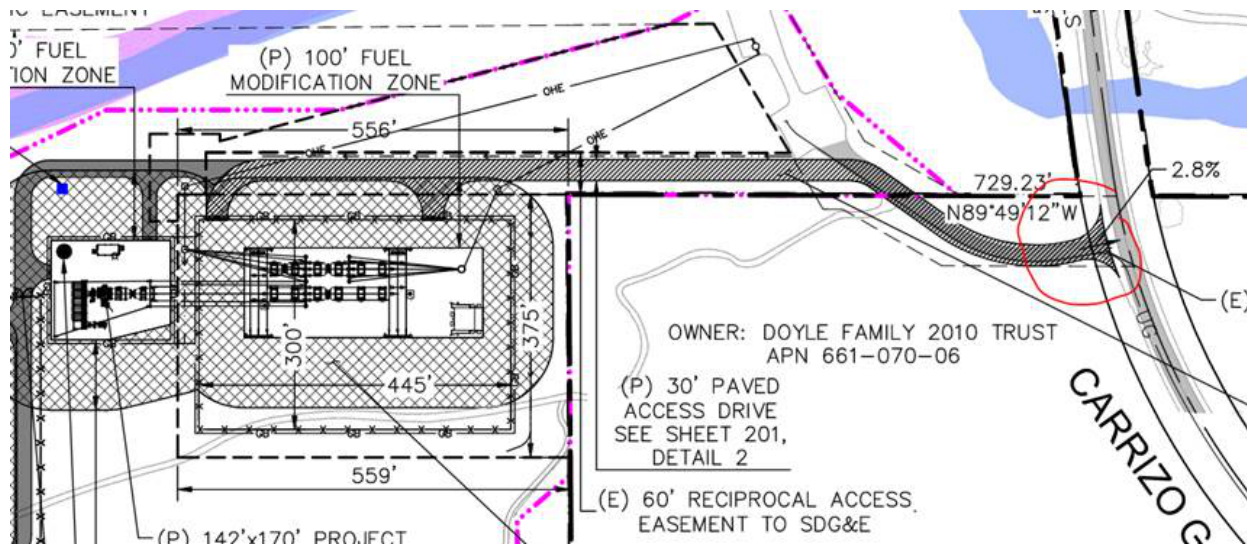

Best Regards,
Tanya

Tatsiana Bondar
Kimley-Horn | 765 The City Drive, Suite 200, Orange, CA 92868
 Direct: 714-705-1338 | www.kimley-horn.com

We Are Moving!

As of January 11th, 2021 we will be in our new location:
 1100 W Town and Country Road, Suite 700
 Orange, CA 92868

 Our phone numbers will remain the same.

From: Bondar, Tatsiana
Sent: Thursday, October 22, 2020 8:41 AM
To: Avalos, Tona <Tona.Avalos@sdcounty.ca.gov>
Cc: Chenoweth, William <william.chenoweth@kimley-horn.com>; Bossu, David <david.bossu@kimley-horn.com>
Subject: RE: JVR Energy Park (PDS2018-MUP-18-022)

Ok thanks, we will reach back out once we're ready to set up a meeting with the traffic engineer.

Best Regards,
Tanya

Tatsiana Bondar
Kimley-Horn | 765 The City Drive, Suite 200, Orange, CA 92868
 Direct: 714-705-1338 | www.kimley-horn.com

From: Avalos, Tona <Tona.Avalos@sdcounty.ca.gov>
Sent: Thursday, October 22, 2020 8:02 AM
To: Bondar, Tatsiana <Tatsiana.Bondar@kimley-horn.com>
Cc: Chenoweth, William <william.chenoweth@kimley-horn.com>; Bossu, David <david.bossu@kimley-horn.com>
Subject: RE: JVR Energy Park (PDS2018-MUP-18-022)

Hi Tanya,
 The tapering question would also involve the Traffic Engineer. Basically anything that would impact the public roads would need involvement from DPW.
 Thanks,
 Tona

From: Bondar, Tatsiana <Tatsiana.Bondar@kimley-horn.com>
Sent: Wednesday, October 21, 2020 5:05 PM

To: Avalos, Tona <Tona.Avalos@sdcounty.ca.gov>
Cc: Chenoweth, William <william.chenoweth@kimley-horn.com>; Bossu, David <david.bossu@kimley-horn.com>
Subject: RE: JVR Energy Park (PDS2018-MUP-18-022)

Hey Tona,

Thanks for following up on this. Sean McLean helped answer our questions and said that we could set up a meeting with the traffic engineer in attendance to discuss the driveway turnaround requirement and discuss if we can forgo it since the site will be low use. We will reach back out to set up a meeting at a later time once we've gathered all our additional questions (correspondence attached for your reference).

However, I did want to ask you about the taper requirement for the driveways and if we really need to taper from edge of existing pavement to the right-of-way or can we taper only to the future roadway width if the roads were to be expanded to the full width per their corresponding street classification?

Thanks and look forward to hearing back.

Best Regards,
Tanya

Tatsiana Bondar
Kimley-Horn | 765 The City Drive, Suite 200, Orange, CA 92868
Direct: 714-705-1338 | www.kimley-horn.com

From: Avalos, Tona <Tona.Avalos@sdcounty.ca.gov>
Sent: Tuesday, October 13, 2020 11:44 AM
To: Bondar, Tatsiana <Tatsiana.Bondar@kimley-horn.com>
Cc: Chenoweth, William <william.chenoweth@kimley-horn.com>; Bossu, David <david.bossu@kimley-horn.com>
Subject: RE: JVR Energy Park (PDS2018-MUP-18-022)

Hi Tanya,
I have been out of the office for a few weeks, so I am not sure if you were able to reach out to anyone else to get a response to your questions below. I believe the driveway would have to be paved with AC pavement to the R/W boundary, I can check with DPW. For the second question, I will also have to check with DPW.

Let me know if you have already gotten a response to this.

Thanks,
Tona Avalos, PE
Civil Engineer
[Planning & Development Services](http://www.sdcounty.ca.gov/planning-development)
County of San Diego
tona.avalos@sdcounty.ca.gov

For local information and daily updates on COVID-19, please visit www.coronavirus-sd.com. To receive updates via text, send COSD COVID19 to 468-311.



From: Bondar, Tatsiana <Tatsiana.Bondar@kimley-horn.com>
Sent: Wednesday, September 16, 2020 6:27 PM
To: Avalos, Tona <Tona.Avalos@sdcounty.ca.gov>
Cc: Chenoweth, William <william.chenoweth@kimley-horn.com>; Bossu, David <david.bossu@kimley-horn.com>
Subject: JVR Energy Park (PDS2018-MUP-18-022)

Hey Tona,

I wanted to reach out regarding JVR Energy Park (PDS2018-MUP-18-022) to find out if the County has a required minimum length that the paved driveways to the site must be, or is the paved surface required all the way to the right-of-way?

We also wanted to discuss the turnaround at the entrance that is required by standard DS-17, DS-18 or DS-19 since we do not believe this is applicable for our site as it is low traffic and those driveways appear to be intended for high use. Would further discussion be required to get approval to use the driveways we show or would we just need to include it in our response to comments in the future?

Best Regards,
Tanya

Tatsiana Bondar

Kimley-Horn | 765 The City Drive, Suite 200, Orange, CA 92868
Direct: 714-705-1338 | www.kimley-horn.com