

**FINAL ARCHAEOLOGICAL LETTER REPORT FOR A NEGATIVE
ARCHAEOLOGICAL SURVEY OF THE STEWART PARCEL AT 12361
LEMON CREST DRIVE (TM-5582) AND PDS2014-ER-14-14-005,
LAKESIDE, CALIFORNIA**

PROJECT PROPONENT:

**ROBERT STEWART
1150 ANCHORAGE LANE
#101
SAN DIEGO, CA 92106**

PREPARED BY:

**RICHARD L. CARRICO
RECUERDOS RESEARCH
PO BOX 387
WARNER SPRINGS, CA
92086**

PRINCIPAL INVESTIGATOR



RICHARD L. CARRICO

Archaeological Survey of 15-acres

Guidelines: CEQA/County of San Diego

USGS Quadrangle: El Cajon 7.5

Township 15 South Range 1 East Unsectioned Portion of the Cajon Land Grant

Keywords: Lakeside, Lemon Crest Drive, Negative Survey

September 10, 2017

1.0 INTRODUCTION AND SUMMARY

This letter report provides the results of an archaeological historical inventory and survey for a 15.1-acre parcel located in Lakeside, California (TM-5582/PDS2014-ER-14-14-005). The property is owned by Bob Stewart. The records search, field survey, and preparation of this letter report were performed in accordance with the California Environmental Quality Act and guidelines of the County of San Diego as one element of approval of a Tentative Map for the study area.

Results of the study were negative; no archaeological or historical resources were recorded at the South Coast Information Center or as a result of the field survey. The proposed project will not impact or adversely affect any recorded or known cultural resources.

2.0 PROJECT LOCATION

The project is located in Lakeside, California off of Lemon Crest Drive and west of Los Coches Road and east of Wintergardens Boulevard (Figures 1 and 2). The street address is 12361 Lemon Crest Drive. As shown on the El Cajon 7.5 USGS quadrangle, the parcel is situated within Township 15 South Range 1 East; in an unsectioned portion of the Cajon land grant at an approximate elevation of 580 feet above mean sea level (msl) (Figure 3).

3.0 ARCHIVAL RESEARCH/RECORDS SEARCH

A self-search records search was conducted at the South Coast information Center on August 18, 2014 (Attachment A: Records Search Request). Results of the search were negative; no archaeological or historical resources were previously recorded on or near the subject parcel (Attachment B: Verification of Records Search). Although the County of San Diego will serve as the Lead Agency and will be ultimately responsible for conducting a Sacred Lands review through the Native American Heritage Commission and complying with SB 18, such a request for a search of the NAHC files was requested (Appendix C); results of the NAHC were negative).



FIGURE 1

PROJECT SITE AS SHOWN ON GOOGLE EARTH
LOS COCHES ROAD IS TO THE RIGHT (EAST)

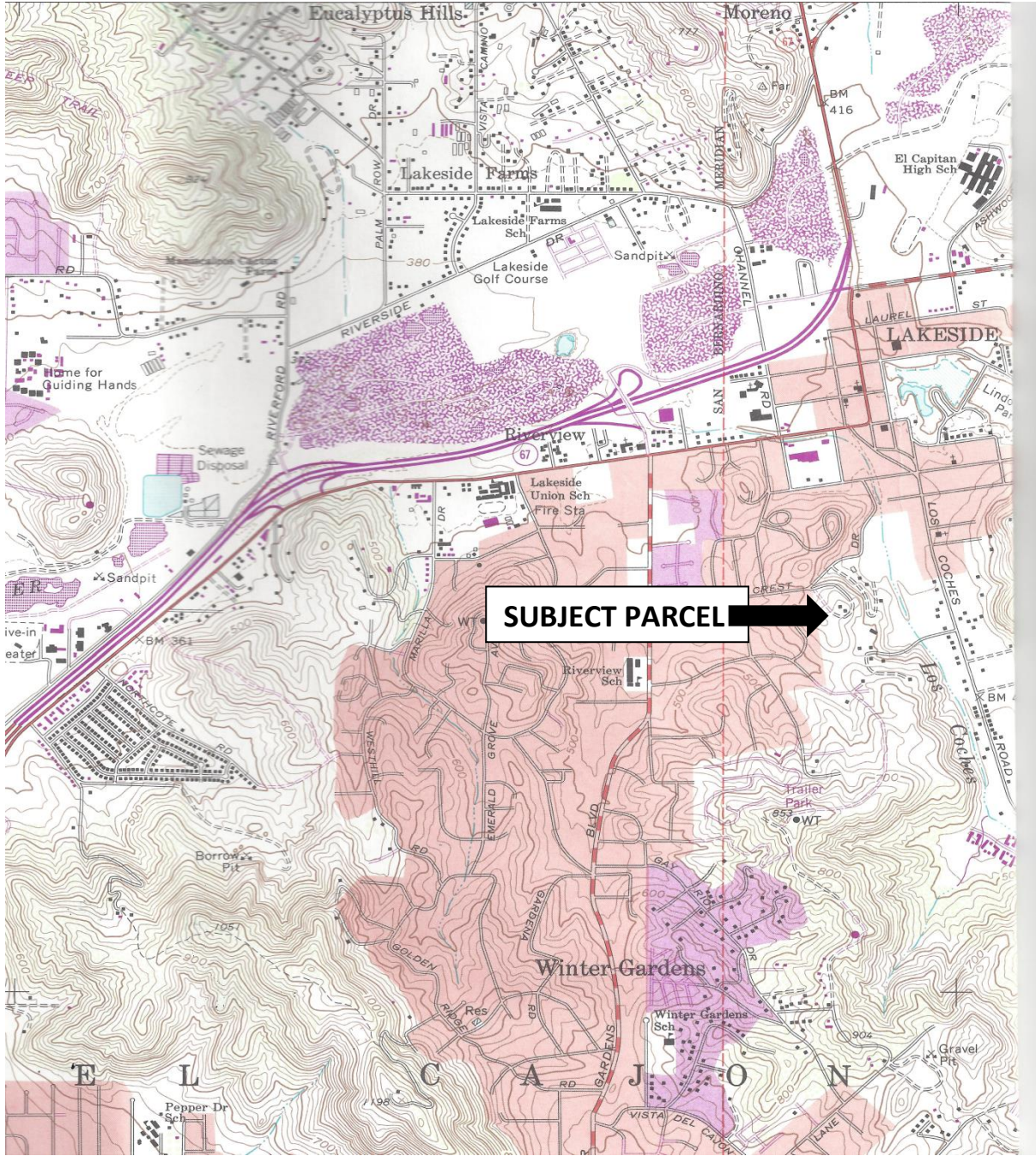

**FIGURE 3:
PROJECT SITE AS DEPICTED ON THE EL CAJON
7.5 MINUTE USGS QUADRANGLE**

It is known that several milling sites and resource exploitation areas exist near Los Coches Creek several hundred feet east from the subject property. A review of historic maps and background did not indicate that any historical roads or buildings existed within the parcel. Los Coches Road, approximately 1,000 feet below the subject property and to the east has been used for hundreds of years as a trail/road linking the San Diego River with the East County.

4.0 SETTING

The subject parcel is a gradually sloping piece of land with slopes trending towards the west. Elevation in the parcel varies from 580 feet above mean sea level (msl) on the north-central highest point to 500 feet above msl on the east. Existing residences were noted on the sides of the parcel. A residence constructed in approximately 1936-1940 once occupied the knoll top but was consumed by fire a few years ago. A partially subsurface cement cistern that served the home is located to the west of the old home site. A surface deposit of modern glass and housing debris lies southeast of the old home site. Wooden sheds/storage rooms are located within the extreme southeastern corner of the property. The soils within the parcel are crumbly brown to dark orange loam with granitic bedrock relatively shallow in the subsoils. Small outcrops of angular bedrock were noted on adjacent properties to the east and south but not within the project. These outcrops were not suitable for milling or food processing. Vegetation on the parcel varies from pockets of non-native grasses, sumac, and buckwheat sporadically across the parcel (especially in the southern portion) to landscaping on including pepper trees in the area of the burned out residence.

5.0 FIELD SURVEY

The field survey was conducted on August 20, 2014, 2014 by Richard L. Carrico acting as the Principal Investigator and Frank Salazar of the Campo Indian Reservation as the Native American Monitor. The survey was conducted by transecting the acreage in north to south transects along the contours spaced at 3 meter intervals. Ground visibility was excellent to moderate with only the presence of small scrubs and bushes (buckwheat and sumac) impairing visibility in small areas on the edges of the property. As an estimate, more than 90% of the ground was visible and the entire parcel was intensively surveyed.

6.0 RESULTS OF THE SURVEY

Results of the field survey were negative; no archaeological resources were noted within the parcel. The acreage has been graded in portions and tilled/brushed over most of the parcel allowing for a thorough examination of surface soils, and in many cases subsoils.

Scattered fragments of modern ceramics and whole, modern glass bottles were noted in the vicinity of the burned and razed residence and are assumed to be refuse or trash associated with that home. The absence of historic or prehistoric resources within the subject parcel is consistent with previous surveys in the region and with the landform within the parcel.

7.0 TRADITIONAL CULTURAL PROPERTIES

Native American Heritage Values

Federal and state laws mandate that consideration be given to the concerns of contemporary Native Americans with regard to potentially ancestral human remains associated funerary objects, and items of cultural patrimony. Consequently, an important element in assessing the significance of the study site has been to evaluate the likelihood that these classes of items are present in areas that would be affected by the proposed project.

Also potentially relevant to prehistoric archaeological sites is the category termed Traditional Cultural Properties in discussions of cultural resource management (CRM) performed under federal auspices. According to Patricia L. Parker and Thomas F. King (1998), “Traditional” in this context refers to those beliefs, customs, and practices of a living community of people that have been passed down through the generations, usually orally or through practice. The traditional cultural significance of a historic property, then, is significance derived from the role the property plays in a community's historically rooted beliefs, customs, and practices. Examples of properties possessing such significance include:

1. A location associated with the traditional beliefs of a Native American group about its origins, its cultural history, or the nature of the world;

2. A rural community whose organization, buildings and structures, or patterns of land use reflect the cultural traditions valued by its long-term residents;
3. An urban neighborhood that is the traditional home of a particular cultural group, and that reflects its beliefs and practices;
4. A location where Native American religious practitioners have historically gone, and are known or thought to go today, to perform ceremonial activities in accordance with traditional cultural rules of practice; and
5. A location where a community has traditionally carried out economic, artistic, or other cultural practices important in maintaining its historic identity.

A Traditional Cultural Property, then, can be defined generally as one that is eligible for inclusion in the National Register because of its association with cultural practices or beliefs of a living community that (a) are rooted in that community's history, and (b) are important in maintaining the continuing cultural identity of the community.

No information related to Traditional Cultural Properties has been obtained through Native American consultation or communication with the Native American monitor during fieldwork. During the current archaeological evaluation, no cultural artifacts or remains were identified or recovered. As such, no Traditional Cultural Properties are known to exist within the project area that current serve religious or other community practices. It should be noted, however, that during the on-going Native American consultation between the County of San Diego and the Tribes new information or concerns may be documented.

8.0 MANAGEMENT RECOMMENDATIONS

The absence of cultural resources within the subject parcel leads to a finding of no adverse effect and of no impacts to significant cultural resources as result of approval of the construction of

four residential units on the parcel. Therefore no mitigating measures or requirements for further study or monitoring are recommended.

**ATTACHMENT A:
REQUEST FOR SELF SEARCH AT SCIC**

Jaime Lennox
SCIC
San Diego State University

August 18, 2014

Re: Request to Conduct Self Search for 12361 Lemon Crest Drive, Lakeside, California Parcel,
Lakeside California. Recuerdos Project #14-0020

Jaime per our e-mail communications of this week I would like to come into SCIC on August 19, 2014, to conduct a self-search of the records and documents for a 15-acre parcel on Lemoncrest Drive located in Lakeside, California. I am completing an archaeological and historical report for the Client for their submittal to the County of San Diego.

This work is being conducted in support of completion of an environmental planning document for a private client. I will be conducting a search within a one-half mile radius of the project site.

Thank you for the opportunity to conduct this self-search.

Richard L. Carrico
Recuerdos Research

**ATTACHMENT B:
VERIFICATION OF SELF SEARCH AT SCIC**



South Coastal Information Center
 San Diego State University
 5500 Campanile Drive
 San Diego, CA 92162-5322
 Office: (619) 594-5672
 www.sci2.org
 sci2@mail.sdsu.edu

**CALIFORNIA HISTORICAL RESOURCES INFORMATION SYSTEM
 CLIENT IN-HOUSE RECORDS SEARCH**

Company: RECUERDOS RESEARCH
Company Representative: RICHARD CARRICO
Date: 8/19/2014
Project Identification: 12361 LEMON CREST DRIVE, LAKESIDE PROJECT #14-0020
Search Radius: within designated boundaries

Historical Resources: SELF
 Titimol and Primary site maps have been reviewed. All sites within the project boundaries and the specified radius of the project area have been plotted. Copies of the site record forms have been included for all recorded sites.

Previous Survey Report Boundaries: SELF
 Project boundary maps have been reviewed. National Archaeological Database (NADB) citations for reports within the project boundaries and within the specified radius of the project area have been included.

Historic Addresses: SELF
 A map and database of historic properties (formerly Geofinder) has been included.

Historic Maps: SELF
 The historic maps on file at the South Coastal Information Center have been reviewed, and copies have been included.

Copies: 55
Hours: 1.5

This is not an invoice. Please pay from the monthly billing statement

**ATTACHMENT C:
REQUEST LETTER TO THE NATIVE AMERICAN
HERITAGE COMMISSION**

Additional Information

- California Native Americans
- Cultural Resources
- Strategic Plan
- Commissioners
- Federal Laws and Codes
- State Laws and Codes
- Local Ordinances and Codes
- Additional Information
- Return to CNARC Home Page

Sacred Lands File & Native American Contacts List Request

NATIVE AMERICAN HERITAGE COMMISSION

915 Capitol Mall, RM 364
 Sacramento, CA 95814
 (916) 653-4082
 (916) 657-5390 - Fax
 nahc@pacbell.net

ATTN:
 GAYLE TOTTON

Information Below is Required for a Sacred Lands File Search

Project: Lemon Crest Drive Tentative Map
 County: SAN DIEGO
 USGS Quadrangle
 Name: EL CAJON
 Township 15S Range 1E Section(s) UNSECTIONED LAND GRANT
 Company/Firm/Agency: See Attached Map.
RECUERDOS RESEARCH
 Contact Person: RICHARD CARRICO
 Street Address: 10321 Del Rio Road
 City: Spring Valley CA Zip: 91978
 Phone: 760-518-1471
 Fax: N/A
 Email: rbrujo@sbcglobal.net

Project Description:

15-acre parcel for tentative map approval. Negative survey. Previous sacred lands search for a parcel approximately 1 mile southwest was negative.

NATIVE AMERICAN HERITAGE COMMISSION

1550 HARBOUR BLVD., SUITE 1100
WEST SACRAMENTO, CA 95601
(916) 373-3710
Fax (916) 373-6471



September 4, 2014

Richard Carrico
Recuerdos Research
10321 Del Rio Road
Spring Valley, CA 91978

Re: Lemon Crest Drive Tentative Map, San Diego County.

Dear Mr. Carrico,

A record search of the sacred land file has failed to indicate the presence of Native American cultural resources in the immediate project area. The absence of specific site information in the sacred lands file does not indicate the absence of cultural resources in any project area. Other sources of cultural resources should also be contacted for information regarding known and recorded sites.

Enclosed is a list of Native Americans individuals/organizations who may have knowledge of cultural resources in the project area. The Commission makes no recommendation or preference of a single individual, or group over another. This list should provide a starting place in locating areas of potential adverse impact within the proposed project area. I suggest you contact all of those indicated, if they cannot supply information, they might recommend others with specific knowledge. By contacting all those listed, your organization will be better able to respond to claims of failure to consult with the appropriate tribe or group. If a response has not been received within two weeks of notification, the Commission requests that you follow-up with a telephone call to ensure that the project information has been received.

If you receive notification of change of addresses and phone numbers from any of these individuals or groups, please notify me. With your assistance we are able to assure that our lists contain current information. If you have any questions or need additional information, please contact me at (916) 373-3712.

Sincerely,

A handwritten signature in blue ink that reads "Katy Sanchez".

Katy Sanchez
Associate Government Program Analyst