

CONCEPTUAL GRADING/BMP PLAN

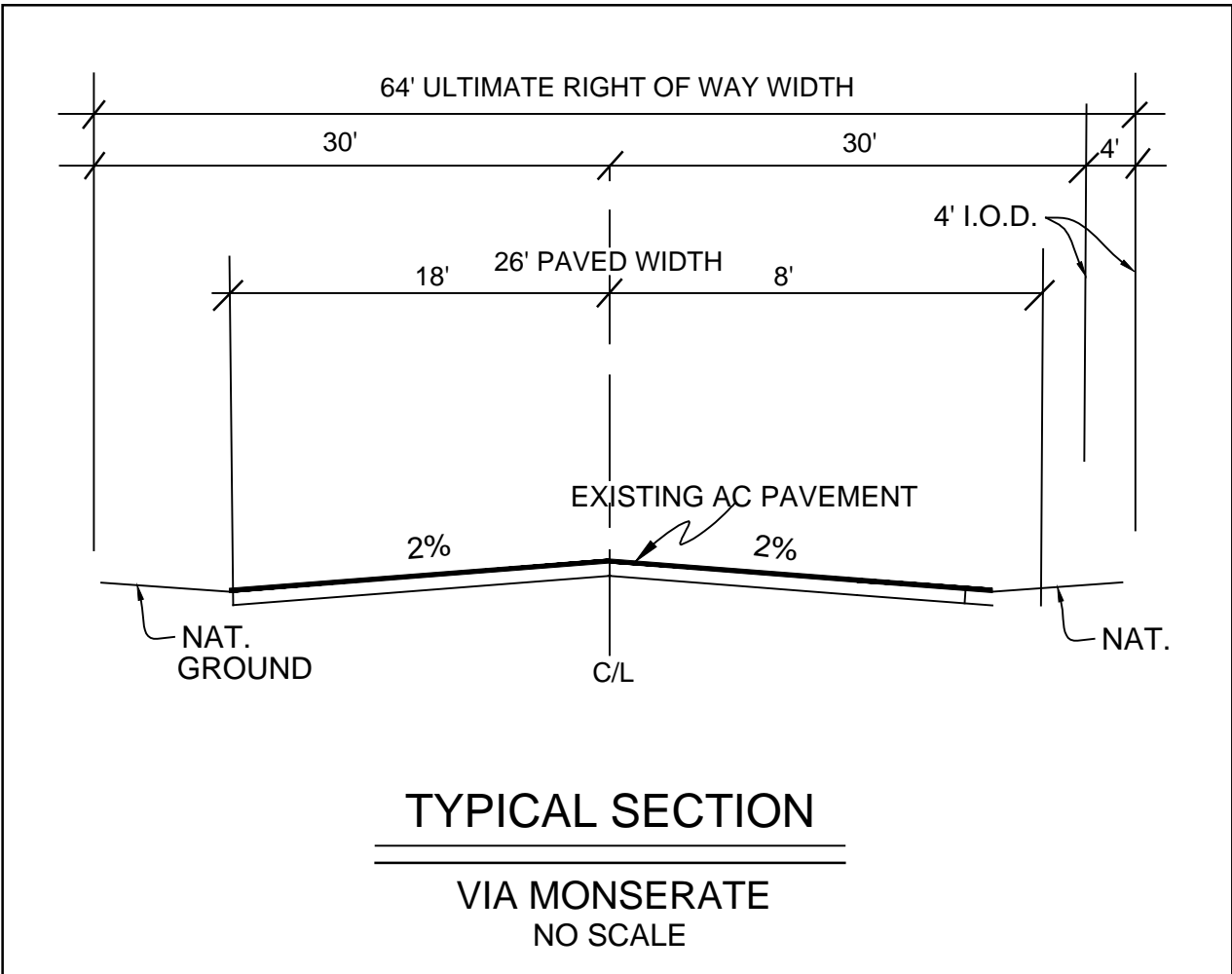
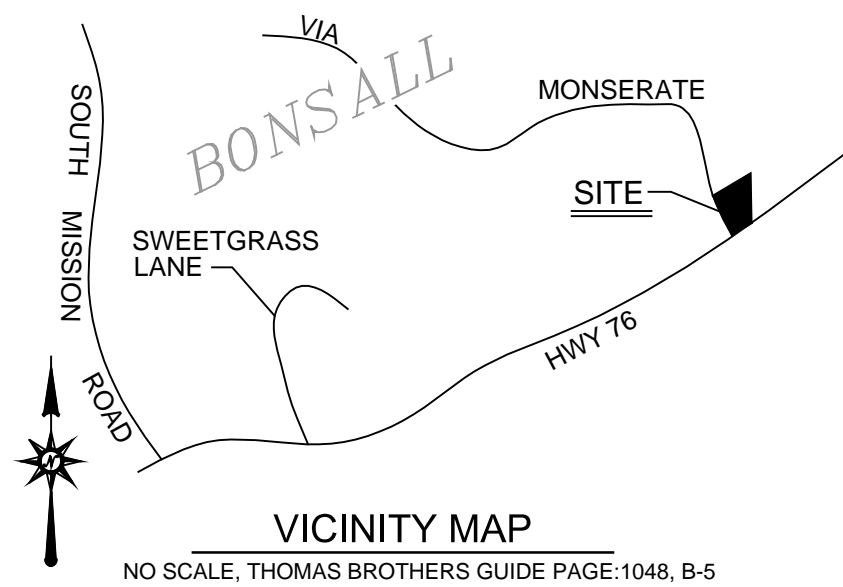

BMP LEGEND		
PDS 659	BROW DITCH	⇒⇒⇒
PDS 659	BERM	→ B →
DIRECTION OF LOT DRAINAGE		
MATERIALS & WASTE MANAGEMENT BMPs:		
WM-1	MATERIAL DELIVERY & STORAGE	
WM-4	SPILL PREVENTION AND CONTROL	
WM-8	CONCRETE WASTE MANAGEMENT	
WM-9	SOLID WASTE MANAGEMENT	
WM-9	SANITARY WASTE MANAGEMENT	
WM-6	HAZARDOUS WASTE MANAGEMENT	
TEMPORARY RUNOFF CONTROL BMPs:		
SS-2	PRESERVATION OF EXISTING VEGETATION	~PEV~PEV~
SS-3	BONDED OR STABILIZED FIBER MATRIX (WINTER)	~M~M~
SS-4	HYDROSEEDING (SUMMER)	~TSP~TSP~
SS-6	SS-8 STRAW OR WOOD MULCH	~S/W~S/W~
SS-7	PHYSICAL STABILIZATION (WINTER)	~EBM~EBM~
SS-10	ENERGY DISSIPATOR	
SC-1	SILT FENCE	—■—■—■—
SC-2	SEDIMENT / DESILTING BASIN	
SC-5	FIBER ROLLS	—FR—FR—
SC-6	SC-8 GRAVEL OR SAND BAGS	—○—○—○—
SC-7	STREET SWEEPING AND VACUUMING	
SC-10	STORM DRAIN INLET PROTECTION	
NS-2	DEWATERING FILTRATION	—DW—DW—
TC-1	STABILIZED CONSTRUCTION ENTRANCE	
TC-2	CONSTRUCTION ROAD STABILIZATION	
TC-3	ENTRANCE / EXIT TIRE WASH	
POST-CONSTRUCTION SITE DESIGN BMPs:		
4.3.1	MAINTAIN NATURAL DRAINAGE PATHWAYS AND HYDROLOGIC FEATURES	
4.3.2	CONSERVE NATURAL AREAS, SOILS, AND VEGETATION	
4.3.3	MINIMIZE IMPERVIOUS AREA	
4.3.4	MINIMIZE SOIL COMPACTION	
4.3.5	IMPERVIOUS AREA DISPERSION	
4.3.6	RUNOFF COLLECTION	
4.3.7	LANDSCAPING WITH NATIVE OR DROUGHT TOLERANT SPECIES	
4.3.8	HARVESTING AND USING PRECIPITATION	
POST-CONSTRUCTION SOURCE CONTROL BMPs:		
4.2.1	PREVENTION OF ILLICIT DISCHARGES INTO THE MS4	
4.2.2	STORM DRAIN STENCILING AND POSTING OF SIGNAGE	
4.2.3	PROTECTED OUTDOOR MATERIALS STORAGE AREAS	
4.2.4	PROTECT MATERIALS STORED IN OUTDOOR WORK AREAS	
4.2.5	PROTECT TRASH STORAGE AREAS	
4.2.6	ADDNL BMPs BASED ON POTENTIAL RUNOFF POLLUTANTS:	
A	ON SITE STORM DRAIN INLETS	
B	INTERIOR FLOOR DRAINS & ELEVATOR SHAFT SUMPS	
C	INTERIOR PARKING GARAGES	
D	NEED FOR FUTURE INDOOR & STR. PEST CONTROL	
E	LANDSCAPE/OUTDOOR PESTICIDE USE	
F	POOLS, SPAS, PONDS, FOUNTAINS, & WATER FEATURES	
G	FOOD SERVICE	
H	TRASH OR REFUSE AREAS	
I	INDUSTRIAL PROCESSES	
J	OUTDOOR STORAGE OF EQUIP. OR MATERIALS	
K	VEHICLE AND EQUIPMENT CLEANING	
L	VEHICLE/EQUIPMENT REPAIR AND MAINTENANCE	
M	FUEL DISPENSING AREAS	
N	LOADING DOCKS	
O	FIRE SPRINKLER TEST WATER	
P	MISCELLANEOUS DRAIN OR WASH WATER	
Q	PLAZAS, SIDEWALKS, DRIVEWAYS, AND PARKING LOTS	

PRELIMINARY GRADING PLAN NOTE:
THIS PLAN IS PROVIDED TO ALLOW FOR FULL AND ADEQUATE DISCRETIONARY REVIEW OF A PROPOSED DEVELOPMENT PROJECT. THE PROPERTY OWNER ACKNOWLEDGES THAT ACCEPTANCE OR APPROVAL OF THIS PLAN DOES NOT CONSTITUTE AN APPROVAL TO PERFORM ANY GRADING SHOWN HEREON, AND AGREES TO OBTAIN A VALID GRADING PERMIT BEFORE COMMENCING SUCH ACTIVITY.

SLOPE ANALYSIS
NOT APPLICABLE

GRADING NOTES
THERE IS NO PROPOSED GRADING ASSOCIATED WITH THIS PROJECT. ALL SLOPES AND STRUCTURES ARE EXISTING AND HAVE BEEN PERMITTED. THERE WILL BE NO CHANGE OF USE ASSOCIATED WITH THIS PROJECT.
4" CONCRETE DRIVEWAY TO BE CONSTRUCTED OVER EXISTING GRADE. NO EARTH MOVEMENT IS PROPOSED.

- GENERAL NOTES
- PERMITTEE'S NAME:
RAYMOND & DIANE WHITE
PO BOX 489
FALLBROOK, CA 92088
 - OWNER'S NAME:
RAYMOND & DIANE WHITE
PO BOX 489
FALLBROOK, CA 92088
 - CIVIL ENGINEER:
KRISTIN GREENE, PE 57860
P.O. BOX 143
BONSALL, CA 92003
(760) 310-9408
 - LEGAL DESCRIPTION: A PORTION OF LOT 36 MAP NO. 2323-SEE RECORD OF SURVEY NO. 18681
 - SITE ADDRESS: 3108 PALA ROAD, FALLBROOK CA 92028
 - APN 124-140-51

EXISTING TOPOGRAPHY PROVIDED BY THE OWNER, ORIGIN UNKNOWN. TOPOGRAPHY OF CALTRANS RECENT IMPROVEMENTS PROVIDED BY dk Greene Consulting DALE GREENE LS 5755 ON AUGUST 10, 2016

SDC PDS RCVD 01-25-18
TPM21257

HIGHWAY 76 HAS RECENTLY BEEN IMPROVED TO ITS ULTIMATE RIGHT OF WAY WIDTH.

(APPROX. C/L)
HIGHWAY 76

Prepared by:
KRISTIN L. GREENE
NOVEMBER 16, 2017
DATE



PRIVATE CONTRACT

COUNTY OF SAN DIEGO
PLANNING AND DEVELOPMENT SERVICES

CONCEPTUAL GRADING/BMP PLAN FOR:
**WHITE PROPERTY
PALA ROAD**

SHEET: 1 OF 1

SYMBOLOLOGY LEGEND

EXISTING STRUCTURE	
EXISTING CONCRETE	
EXISTING ASPHALT	
EXISTING GRAVEL	
PROPOSED CONCRETE	

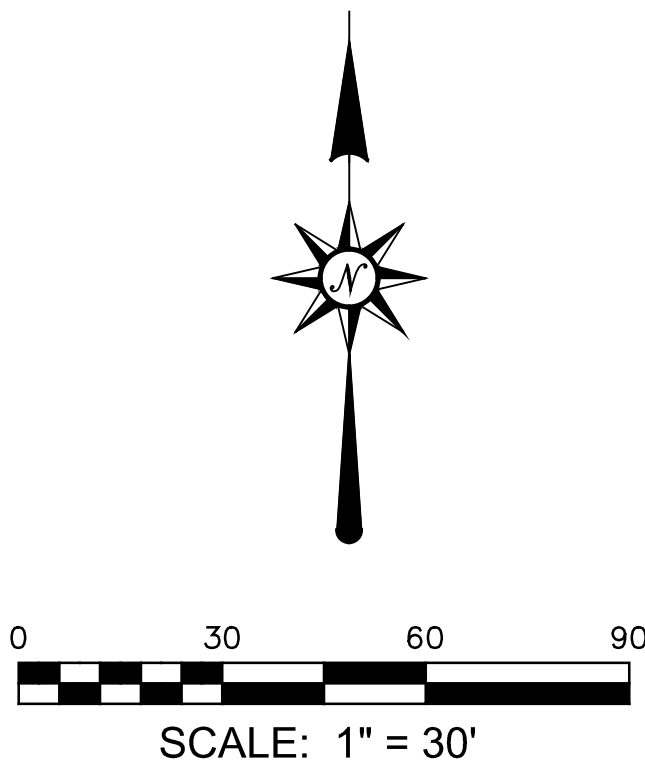

dk Greene Consulting, Inc.
P.O. BOX 143
BONSALL, CA 92003
(760) 310-9408

