

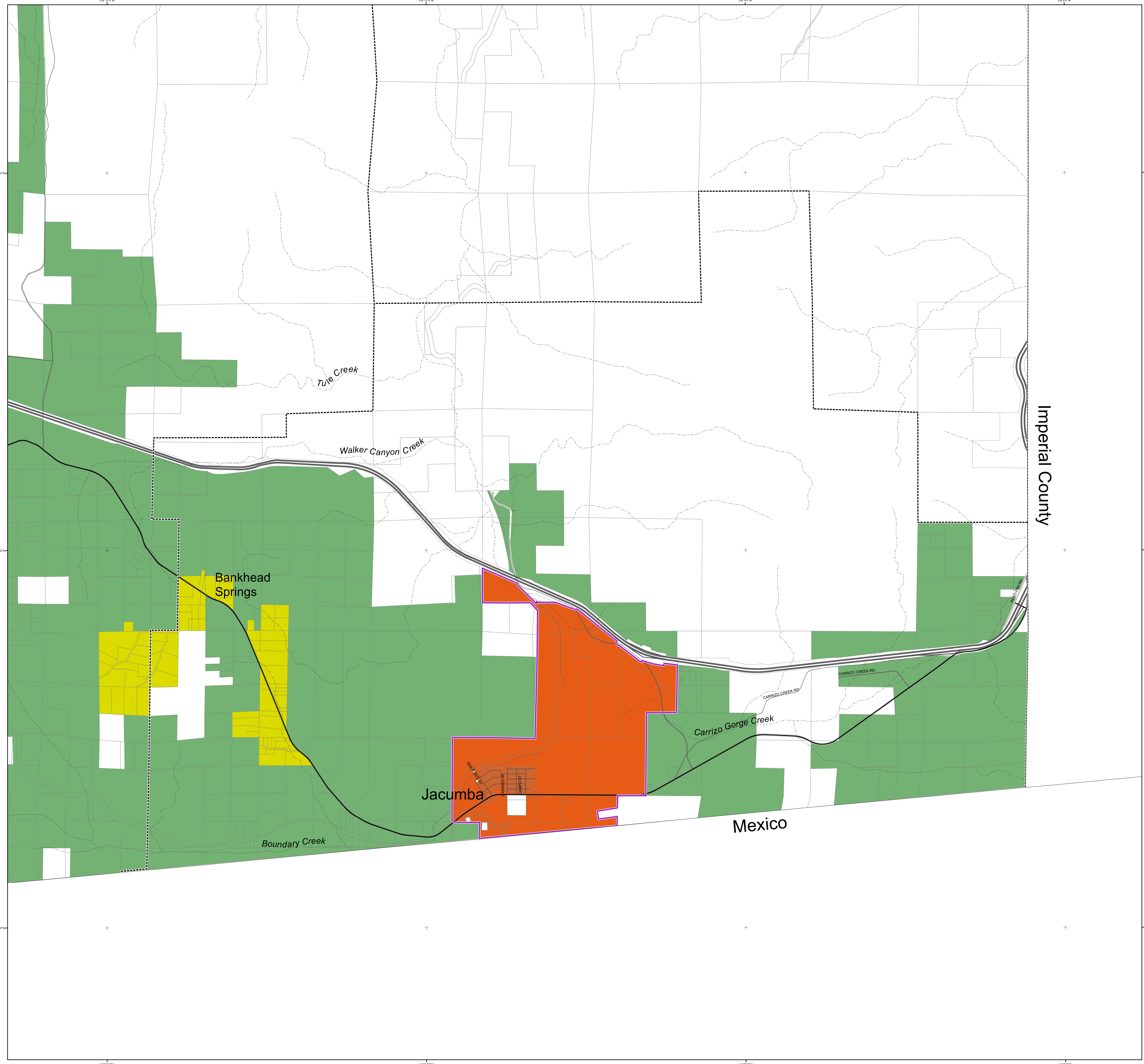

GENERAL PLAN
Jacumba
Subregional Group Area

Regional Category Map

- Village
- Rural
- Semi-Rural
- Rural Village Boundary
- Special Study Area
- Village Boundary
- Parcels
- Lakes
- County Water Authority Boundary
- Planning Boundary



Map Prepared By:
LUEGGIS
Geographic Information Services

Coordinates: NAD83 Feet

THIS MAP/DATA IS PROVIDED WITHOUT WARRANTY OF ANY KIND, EITHER EXPRESS OR IMPLIED, INCLUDING BUT NOT LIMITED TO, THE IMPLIED WARRANTIES OF MERCHANTABILITY AND FITNESS FOR A PARTICULAR PURPOSE. Also, this product may contain information reproduced with permission from SANDAG's Information System which cannot be reproduced without the written permission of SANDAG. This product may contain information reproduced with permission granted by RAND McNALLY & COMPANY™ to SANDAG. This map is copyrighted by RAND McNALLY & COMPANY™. It is unlawful to copy or reproduce all or any part thereof, whether for personal use or resale, without the prior, written permission of RAND McNALLY & COMPANY™.

Copyright SANDAG 2009. All Rights Reserved. Full text of this legal notice can be found at: http://www.sandag.org/Legal_Notice.htm

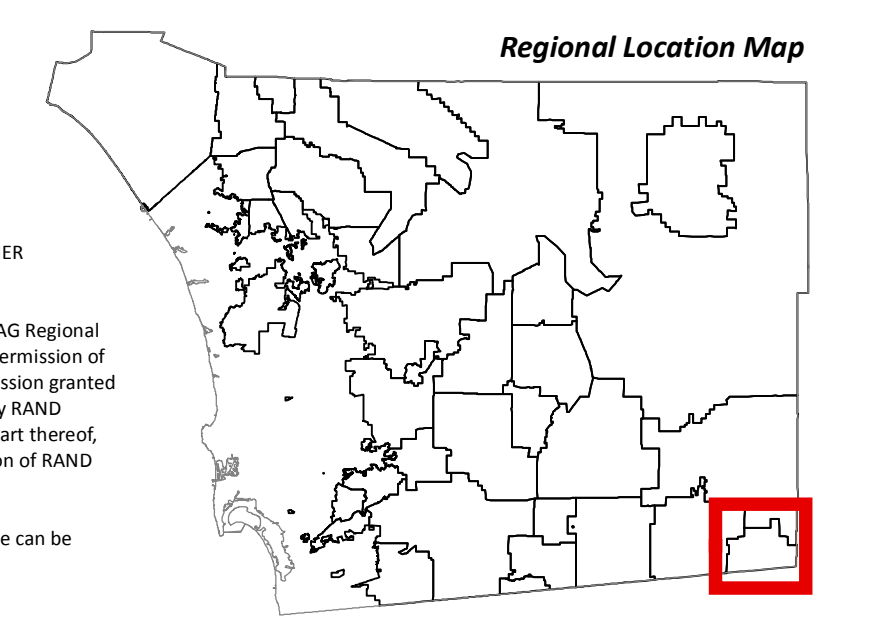

Source: County of San Diego, SANDAG, SANDAG
Document Path: S:\land_use\gpub\data_maps\lcm\map\resources\structure_atlas.mxd

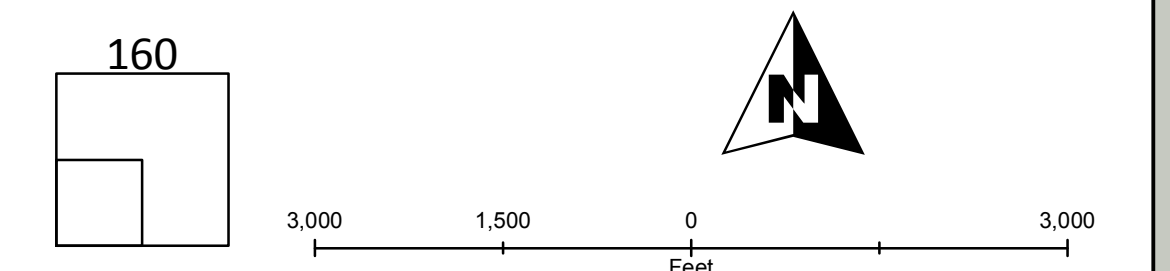

Map Date: 1/13/2017